



Wishes Quilt Along

Block Seven - Court House Lawn



Cutting:

| | | |
|---|---|---------------------------------|
| A | 3 | 4 3/4" squares |
| B | 5 | 3" squares |
| C | 2 | 2 5/8" squares |
| D | 4 | 3" squares |
| E | 4 | 3" x 5 1/2" rectangles |
| F | 4 | 3" squares (from each Fabric F) |

Use 1/4" seams and press as arrows indicate throughout.

Cut the Fabric A squares on the diagonal twice.



Make twelve.

Cut the Fabric C squares on the diagonal once.



Make four.

Assemble two Fabric B squares and one Fabric D square as shown.

Top/Bottom Nine Patch Unit should measure 3" x 8".

Make two.



Make two.

Assemble two Fabric D squares and one Fabric B square as shown.

Middle Nine Patch Unit should measure 3" x 8".

Make one.

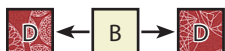

Make one.

Assemble Nine Patch Unit as shown.

Nine Patch Unit should measure 8" x 8".

Make one.

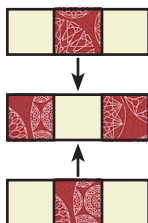

Make one.

Assemble one Fabric A triangle and one Fabric F square as shown.

Make eight total.



Make two.



Make two.



Make two.



Make two.

Assemble two Fabric A/F Units and one Fabric E rectangle as shown.

Make four total.

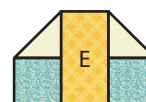
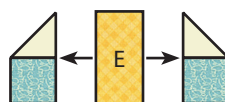

Make two.

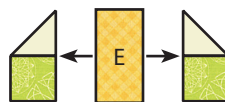

Make two.

Assemble one Fabric C triangle and one Fabric A/F/E Unit as shown.

Make four total.

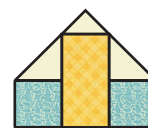
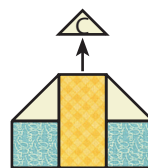

Make two.

Blue Court House Unit.

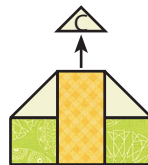

Make two.

Green Court House Corner Unit.

Assemble two Fabric A triangles and one Blue Court House Unit as shown.

Make two Blue Court House Corner Units.



Make two.



MAKE-A-WISH
Central & South Texas

You can help by donating to Make-A-Wish through
the [Wishes Quilt Along donation page](http://www.FatQuarterShop.com).





Wishes Quilt Along



Block Seven - Court House Lawn

Assemble two Green Court House Corner Units and one Nine Patch Unit as shown.

Make one.

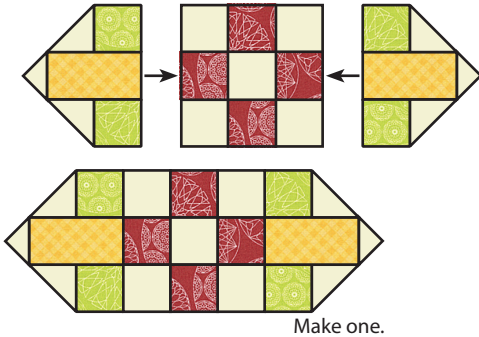

Assemble Block Seven as shown.

Block Seven should measure 14 1/2" x 14 1/2".

Make one.

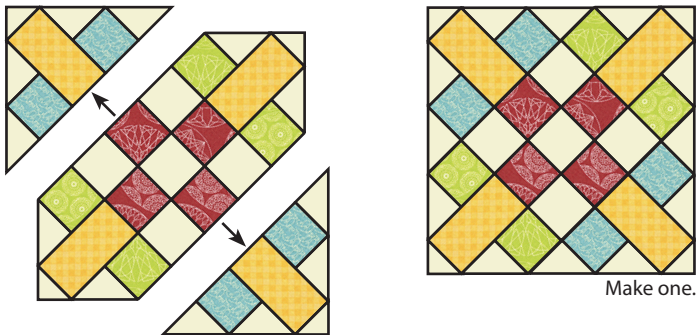

[You can help by donating to Make-A-Wish through the Wishes Quilt Along donation page.](#)

