



# A Little Birdie Told Me

**A Little Birdie Told Me**...that a Kimberbell **Love Notes Mystery Quilt** is coming! While you wait, enjoy creating our adorable petite pillow. Stitched in a raw-edge applique technique, the **Embroidery Leather** songbird "tweets" her heartfelt message, the entire applique design framed within a beautiful flange border. Our **A Little Birdie Told Me Pillow** anticipates a quilt you'll be "twitterpated" with, so sign up for the **Love Notes Mystery** at your favorite quilt shop today!

## Materials Needed

### Fabric

Fabric 1: Background	1 Fat Quarter
Fabric 2: Borders & Back	1 Fat Quarter
Fabric 3: Speech Bubble	1 Fat Sixteenth
Fabric 4: Heart	Fabric Scrap

### Kimberbell Products

KDKB1202 Embroidery Leather	(1) Robin's Egg Blue
KDKB201 Pillow Insert	(1) 8 x 8"

### Other

Fusible Woven Interfacing  
 Lightweight Fusible Web  
 Embroidery Floss:  
 Orange (Cosmo 145)    Pink (Cosmo 2115)  
 Black (Cosmo 600)

## Cutting Instructions

### Fabric 1

Background                      cut **(1)** 10½ x 10½"

### Fabric 2

Flange Border A & B            cut **(2)** 1½ x 8½"  
 Flange Border C & D           cut **(2)** 1½ x 10½"  
 Back Pieces                      cut **(2)** 7 x 10½"

### Fabric 3

Speech Bubble                   cut **(1)** 5½ x 5½"

### Fabric 4

Heart                                cut **(1)** 4 x 4"

### Robin's Egg Blue Embroidery Leather

Bird                                cut **(1)** 2½ x 3"  
 Wing                               cut **(1)** 2 x 2"

## Applique Instructions

We love the simplicity of using lightweight fusible web for applique. All of the images are printed in reverse, ready for tracing. To begin, you will need the applique image, lightweight fusible web, pencil, and an iron.

1. Place fusible web, **paper side up**, over the applique designs. Trace with a pencil.
2. Trim around the shapes, but not directly on the outline.

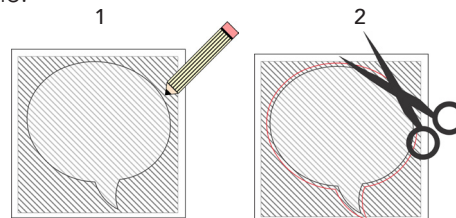

3. With a warm iron, adhere fusible web to the **wrong side** of the fabric.  
**Note:** The process of applique for Embroidery Leather is the same as fabric. Always use a pressing cloth when ironing Embroidery Leather.
4. Cut out the fabric shape directly on the traced pencil outline.

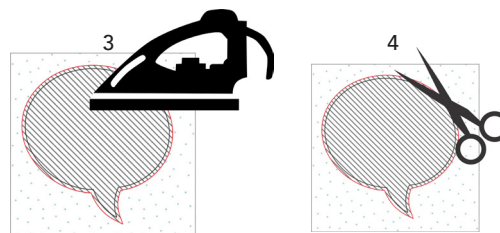

5. Peel fusible web paper from fabric.
6. With iron, fuse woven interfacing to wrong side of Background Fabric.

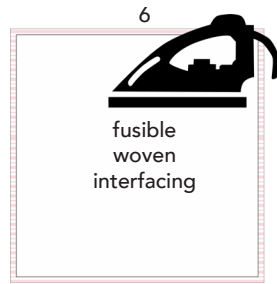
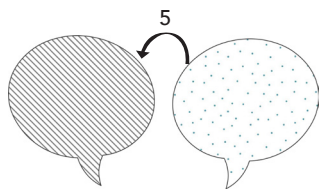

7. With a disappearing pen, trace the design onto the Background Fabric.
8. Place applique pieces onto the Background Fabric. With a warm iron, fuse the fabric shapes to the fabric.  
**Note:** Use a pressing cloth when ironing Embroidery Leather.

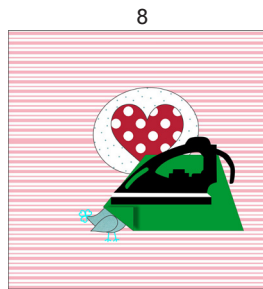
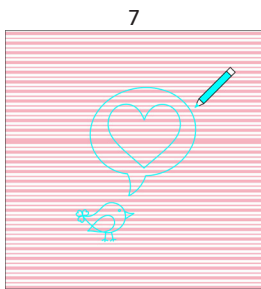

9. Set sewing machine to zigzag or blanket stitch and sew around the applique shapes to finish the edges.  
 < In addition to zigzag and blanket stitches (sometimes called buttonhole stitch), straight stitches sewn just inside the perimeter of the applique can nicely outline the shape, leaving the edges to lightly fray.
10. Backstitch the legs with 3 strands orange embroidery floss. Refer to Hand Embroidery Instructions.
11. Satin stitch the beak with 3 strands orange embroidery floss.
12. Satin stitch the heart tail feathers with 3 strands pink embroidery floss.
13. Using placement template, mark the placement of the eye. Satin stitch the eye with 3 strands black embroidery floss.

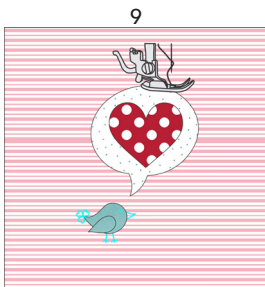

## Hand Embroidery Instructions

### Backstitch

1. Bring embroidery floss up from **back of fabric** through point A. Pull floss all the way through.
2. Insert needle down behind point A to point B. Pull floss through to the **back side**.
3. Bring needle up at point C, pulling floss through to the **front**. Try to keep the length of stitch consistent between points A-B and C-A.
4. Insert needle down at point D close to point A so that the stitches begin to form a line.
5. Repeat backstitch sequence until shape is outlined in stitches.

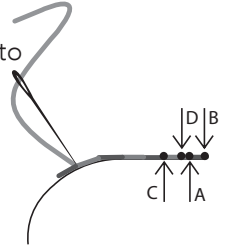

### Satin Stitch

Before starting the satin stitch, outline the embroidery shape with a Backstitch. To help keep your stitches even, come up from the back of the design at the widest point of the shape to begin.

1. Bring needle up from **back of fabric**, alongside the outside edge of outline stitches through point A.
2. Insert the needle directly across the shape at point B pulling floss taut in a straight line.
3. Bring needle up from back, close to the first stitch (Point A) and pull floss through.
4. Keeping stitches close together, continue satin stitches back and forth across the shape until it is filled in.

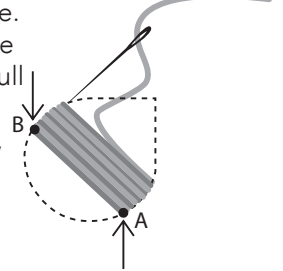

## Trimming Instructions

Trim block to measure  $8\frac{1}{2} \times 8\frac{1}{2}$ "

Kimberbell's Orange Pop Rulers are perfect for squaring up blocks.



1. Visually center the embroidered design using the  $8\frac{1}{2} \times 8\frac{1}{2}$ " Orange Pop Ruler.
  2. Cut all edges of the block. Beginning at the edge closest to you, insert rotary cutter into the extended corner channel. Carefully cut against the edge of the ruler.
- Note:** We recommend using a rotating cutting mat for best results.
3. Remove embroidered block from the Orange Pop Ruler.

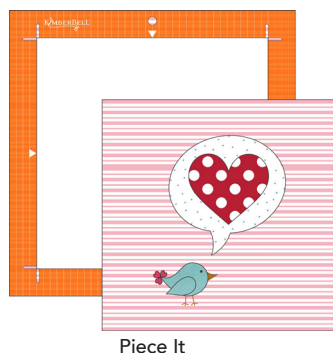
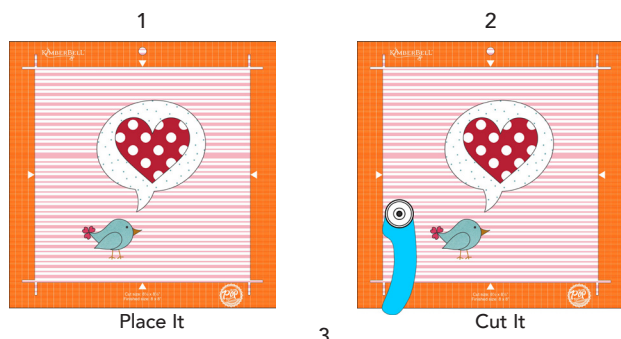

## Sewing Instructions

1. **Right sides together (RST)**, sew Border Pieces A & B to the left and right of the pillow center, using a  $\frac{1}{4}$ " seam allowance. Press seams to flange border.  
**Note:** Do not place iron directly on Embroidery Leather. Always press pillow from back.
2. **RST**, sew Border Pieces C & D to the top and bottom of the pillow center, using a  $\frac{1}{4}$ " seam allowance. Press seams to flange border.

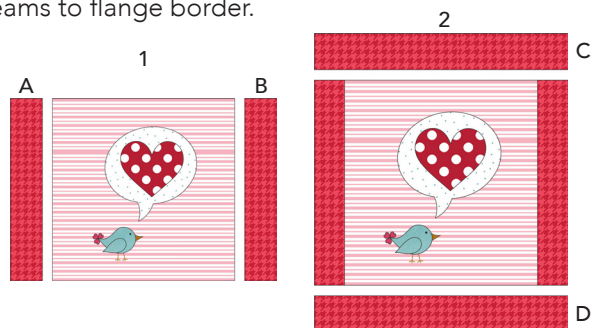

3. Prepare both Back Pieces for an envelope style closure by turning fabric  $\frac{1}{4}$ " to the **back** on one long side. Press well. Turn another  $\frac{1}{4}$ " and press again. Pin the hem and topstitch.
4. Place pillow top **right side up**. Place Back Pieces **right side down** over pillow top, aligning raw edges and overlapping hemmed edges.

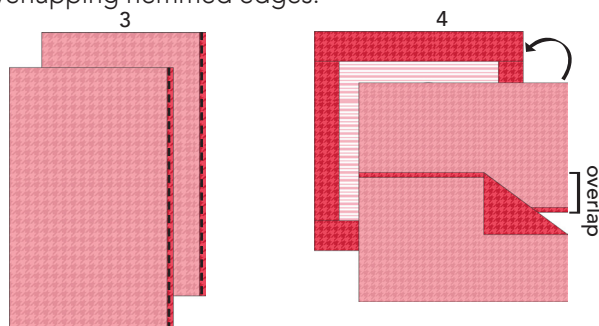

5. Sew around the perimeter of the pillow top with  $\frac{1}{4}$ " seam allowance.
6. Clip corners to reduce bulk.
7. Turn pillow **right side out**. Poke corners with a blunt tip to square. Press well. Do not place iron directly on Embroidery Leather. Always press pillow from back.
8. The border flange is created by sewing through all layers of the pillow including the back. Stitch in the ditch on the seam line between the border and pillow center. Insert pillow form.

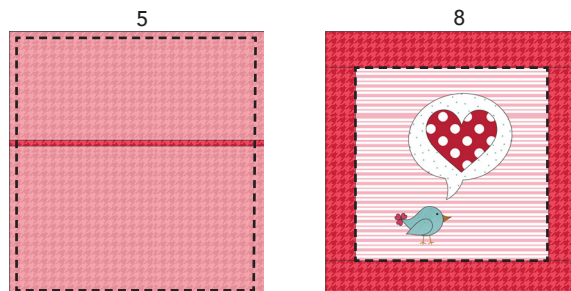

## Designs to Trace & Placement Templates

- Applique designs are in reverse and ready for tracing.
- Placement templates are ready for tracing for hand embroidery. These images can also be used as a placement guide.

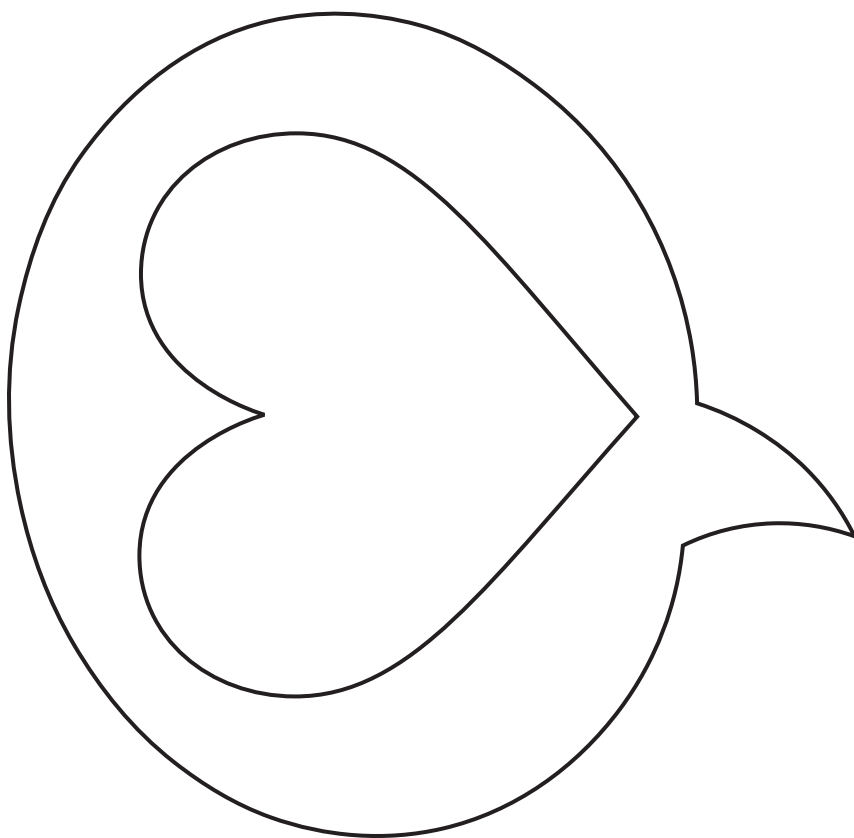
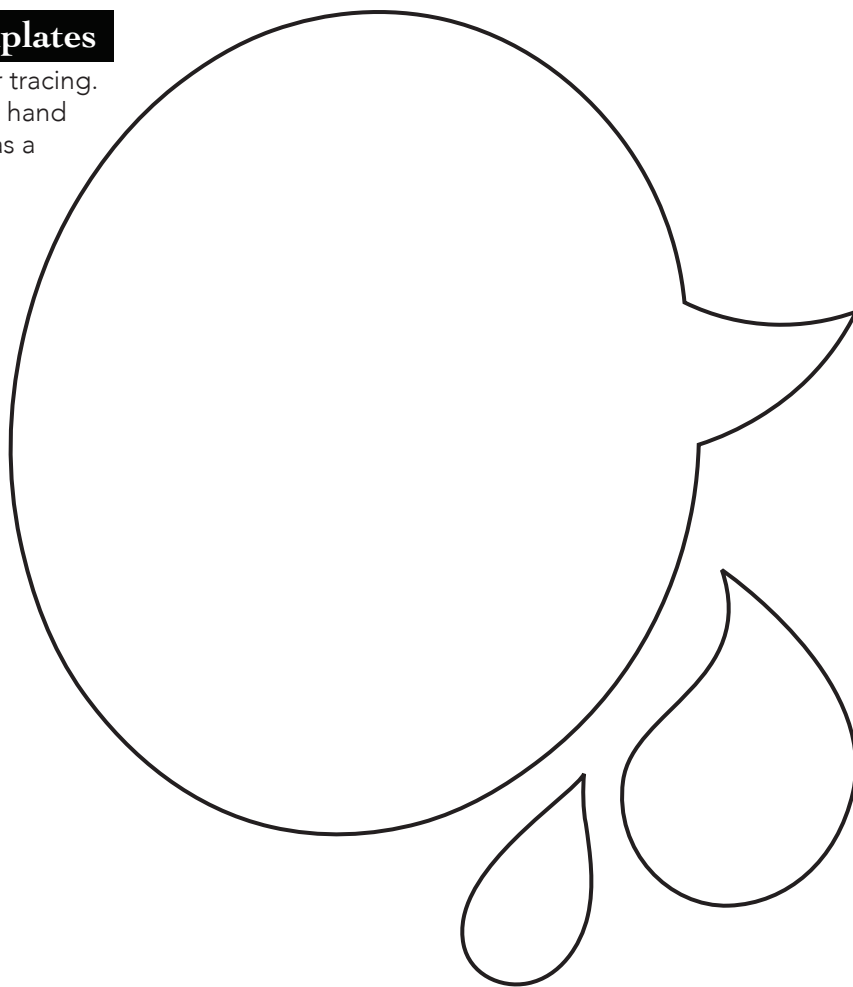
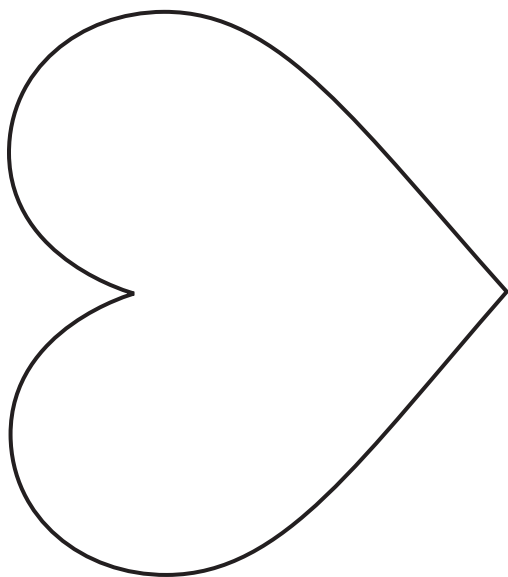

A Little Birdie Told Me Placement Template

