

Faux Feathered Star

Quilt Pattern

Fat Quarter Shop Exclusive!

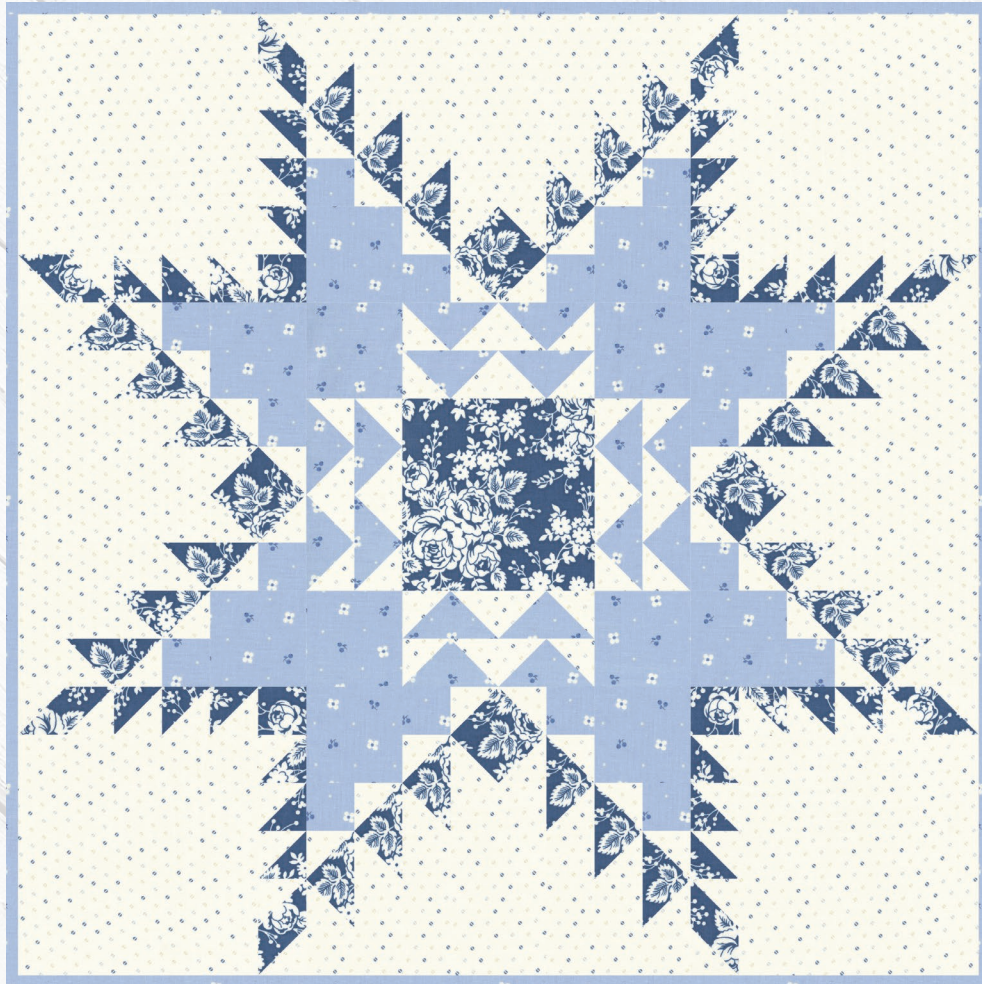
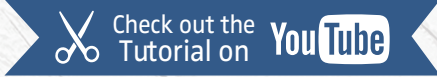

Finished Size: 40 1/2" x 40 1/2"

The Faux Feathered Star Quilt is made from the
Blueberry Delight collection by Bunny Hill Designs for Moda Fabrics.



#FauxFeatheredStar

www.FatQuarterShop.com





© 2023 Fat Quarter Shop, LLC. All rights reserved. Duplication of any kind is prohibited. This pattern may be used for personal purposes only and may not be reproduced without the express written permission from Fat Quarter Shop. This pattern may not be used for commercial purposes. This pattern may only be hosted, accessed, and downloaded from www.FatQuarterShop.com.



Faux Feathered Star

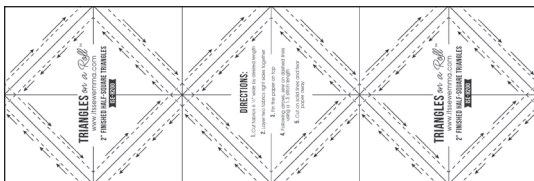
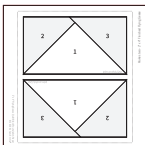

Cutting:

	Fabric	Yardage	Letters	Sizes & Quantities
Background 3039-11		1 7/8 yards	A	4 - 10 1/2" squares
			B	1 - 6 1/2" x 17 1/2" rectangle
			C	4 - 4 1/2" x 8 1/2" rectangles
			D	40 - 3 1/2" squares
			E	8 - 2 1/2" x 6 1/2" rectangles
			F	8 - 2 1/2" x 4 1/2" rectangles
			G	8 - 2 1/2" squares
			H	32 - 2 1/2" squares
Block Print 3030-16		1 1/8 yards	I	1 - 8 1/2" square
			J	1 - 6 1/2" x 17 1/2" rectangle
			K	12 - 5" x 5 3/4" rectangles
			L	4 - 4 1/2" squares
			M	8 - 2 1/2" x 4 1/2" rectangles
			N	4 - 2 1/2" squares
Block Print & Binding 3034-13		1 1/8 yards	O	8 - 5" x 5 3/4" rectangles
			P	12 - 4 1/2" squares
			Q	16 - 2 1/2" squares
			R	5 - 2 1/2" x width of fabric strips (binding)
Backing 3039-11		2 7/8 yards		
One roll 2" Half Square Triangle Paper Triangles on a Roll #H200 1 - two by six section (12 squares)				
One pad 2" x 4" Flying Geese Quilt Block Foundation Paper #ISE-776 20 sheets				



Faux Feathered Star



Use 1/4" seams and press as arrows indicate throughout.

Corner Blocks:

Draw a diagonal line on the wrong side of the Fabric H squares.

With right sides facing, layer a Fabric H square on the top end of a Fabric M rectangle.

Stitch on the drawn line and trim 1/4" away from the seam.



Repeat on the bottom end.

Side Star Point Unit should measure 2 1/2" x 4 1/2".



With right sides facing, layer the Fabric B rectangle with the Fabric J rectangle.

Place a two by six section of 2" Finished Half Square Triangle Paper on top and pin in place.

Set stitch length to 1.5 and sew on the dotted lines.

Cut apart on the solid lines.

Half Square Triangle Unit should measure 2 1/2" x 2 1/2".

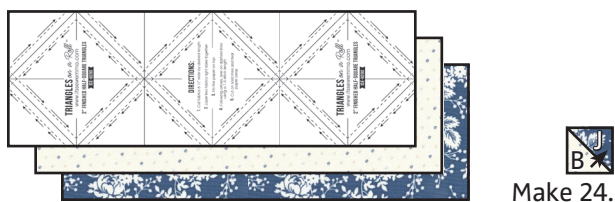

Assemble Unit.

Side Unit should measure 2 1/2" x 10 1/2".

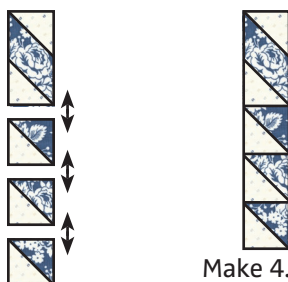

With right sides facing, layer a Fabric H square on one end of a Fabric M rectangle.

Stitch on the drawn line and trim 1/4" away from the seam.



Repeat on the opposite end.

Bottom Star Point Unit should measure 2 1/2" x 4 1/2".



Assemble Unit.

Bottom Unit should measure 2 1/2" x 12 1/2".

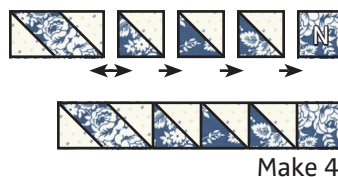

Assemble Block.

Corner Block should measure 12 1/2" x 12 1/2".

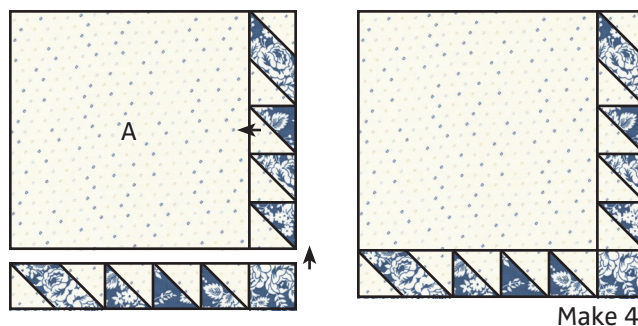



Faux Feathered Star



Feathered Star Blocks:

Cut the Fabric D squares on the diagonal once.



Make 80.

Following the instructions on the Flying Geese Foundation Paper, layer a Fabric K rectangle in the Placement 1 position on the Flying Geese paper.

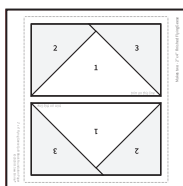
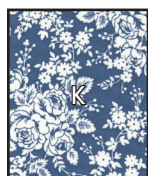

Following the instructions on the paper, use the Fabric D triangles for Placements 2 and 3.

Flying Geese Unit should measure $2\frac{1}{2}'' \times 4\frac{1}{2}''$.



Make 24.

Assemble Unit.

First Partial Left Unit should measure $4\frac{1}{2}'' \times 12\frac{1}{2}''$.

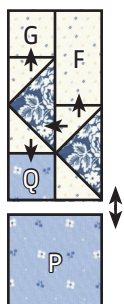

Make 4.

Assemble Unit.

Second Partial Left Unit should measure $2\frac{1}{2}'' \times 12\frac{1}{2}''$.



Make 4.

Assemble Unit.

Left Unit should measure $6\frac{1}{2}'' \times 12\frac{1}{2}''$.



Make 4.

With right sides facing, layer Fabric H squares on opposite corners of a Fabric L square.

Stitch on the drawn lines and trim $\frac{1}{4}''$ away from the seams.



Repeat on the remaining corners.

Diamond Unit should measure $4\frac{1}{2}'' \times 4\frac{1}{2}''$.

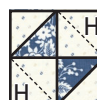

Make 4.



Faux Feathered Star



Assemble Unit.

Middle Unit should measure 4 1/2" x 12 1/2".

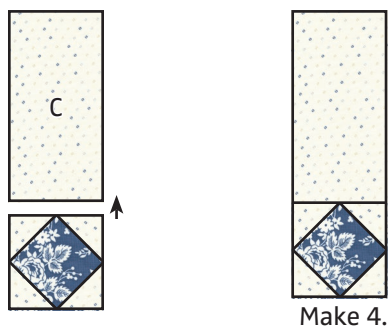

Assemble Unit.

Right Unit should measure 6 1/2" x 12 1/2".

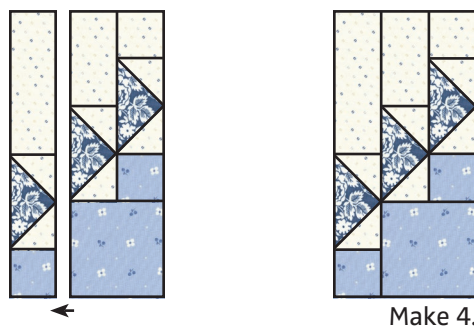

Assemble Unit.

First Partial Right Unit should measure 2 1/2" x 12 1/2".

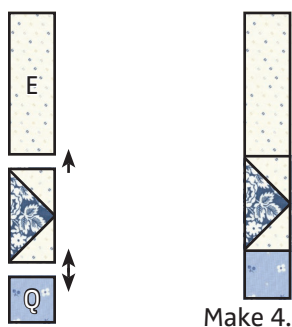

Assemble Block.

Feathered Star Block should measure 12 1/2" x 16 1/2".

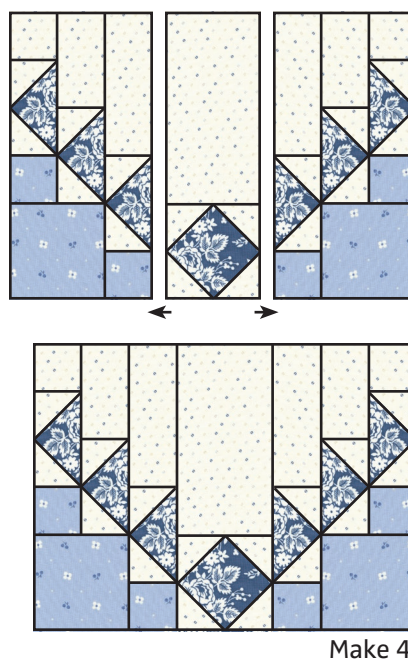

Assemble Unit.

Second Partial Right Unit should measure 4 1/2" x 12 1/2".

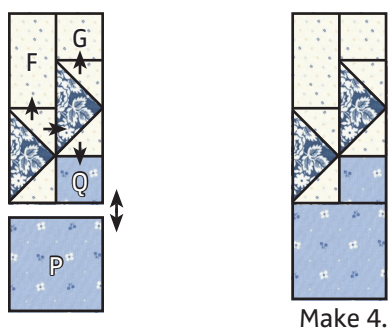



Faux Feathered Star



Center Block:

Following the instructions on the Flying Geese Foundation Paper, layer a Fabric O rectangle in the Placement 1 position on the Flying Geese paper.

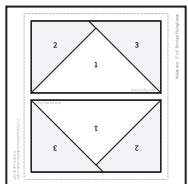

Following the instructions on the paper, use the Fabric D triangles for Placements 2 and 3.

Center Flying Geese Unit should measure $2\frac{1}{2}'' \times 4\frac{1}{2}''$.



Make 16.

Assemble Unit.

Center Unit should measure $4\frac{1}{2}'' \times 8\frac{1}{2}''$.

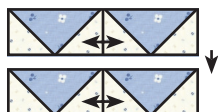

Make 4.

Assemble Block.

Center Block should measure $16\frac{1}{2}'' \times 16\frac{1}{2}''$.

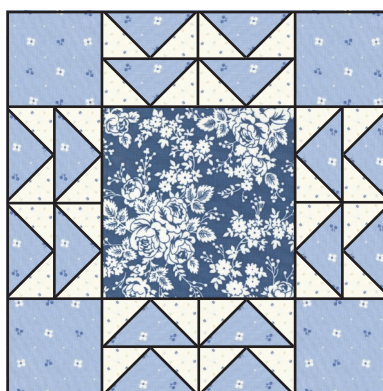
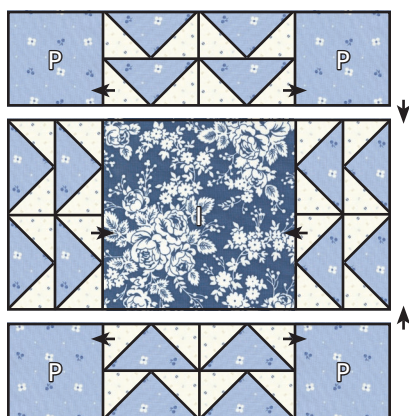

Make 1.



Faux Feathered Star



Quilt Center:

Assemble Quilt Center. Press open.

Quilt Center should measure 40 1/2" x 40 1/2".

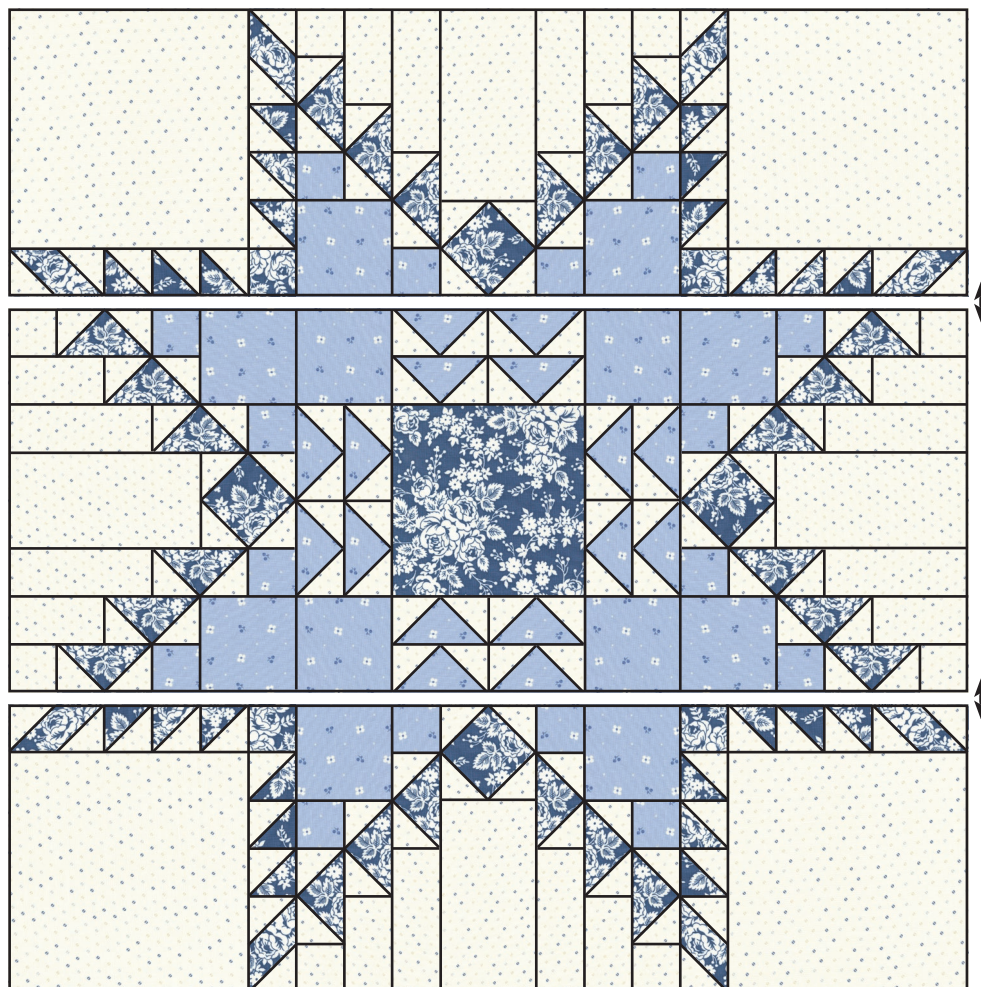

Finishing:

Piece the Fabric R strips end to end for binding.

Quilt and bind as desired.