

All the Trimmings

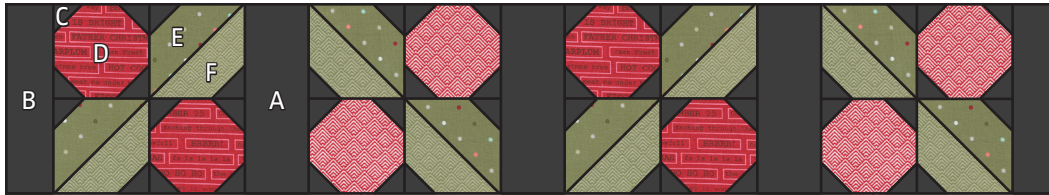



MYSTERY QUILT ALONG
FAT QUARTER SHOP EXCLUSIVE

Week One - Holly Row:



Unfinished size: 6 1/2" x 33 1/2"

Cutting:

Background 9900-118 	A 3 - 2 1/2" x 6 1/2" rectangles B 2 - 2" x 6 1/2" rectangles C 48 - 1 1/2" squares
Holly Berry Prints 2 LC Squares  	D 4 - 3 1/2" squares (8 total)
First Leaf Print 1 LC Square 	E 4 - 4" squares Δ
Second Leaf Print 1 LC Square 	F 4 - 4" squares Δ

LC = Layer Cake Square

Δ Optional: You can use 3" Finished Half Square Triangle Paper (#H300) by Triangles on a Roll. Watch the video tutorial for tips.

Use 1/4" seams and press as arrows indicate throughout.

Block Assembly:

Draw a diagonal line on the wrong side of the Fabric C squares.

With right sides facing, layer Fabric C squares on opposite corners of a Fabric D square.

Stitch on the drawn lines and trim 1/4" away from the seams.



Repeat on the remaining corners.

Block Unit should measure 3 1/2" x 3 1/2".



Make 4.

Make 4.

Draw a diagonal line on the wrong side of the Fabric E squares.

With right sides facing, layer a Fabric E square with a Fabric F square.

Stitch 1/4" from each side of the drawn line.

Cut apart on the marked line.

Trim Half Square Triangle Unit to measure 3 1/2" x 3 1/2".

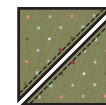
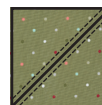

Make 8.

TO FIND THE KIT, PATTERNS & MORE!

WWW.FATQUARTERSHOP.COM/SEW-ALONGS/
ALL-THE-TRIMMINGS

#AllTheTrimmingsQAL

WWW.FATQUARTERSHOP.COM



All the Trimmings

MYSTERY QUILT ALONG
FAT QUARTER SHOP EXCLUSIVE

With right sides facing, layer a Fabric C square on the top left corner of a Half Square Triangle Unit. Stitch on the drawn line and trim $\frac{1}{4}$ " away from the seam.



Repeat on the bottom right corner.
Leaf Unit should measure $3\frac{1}{2}$ " x $3\frac{1}{2}$ ".

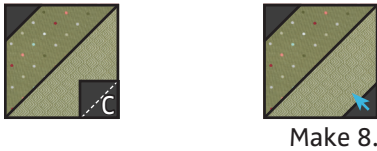

Assemble Block.

Holly Block should measure $6\frac{1}{2}$ " x $6\frac{1}{2}$ ".

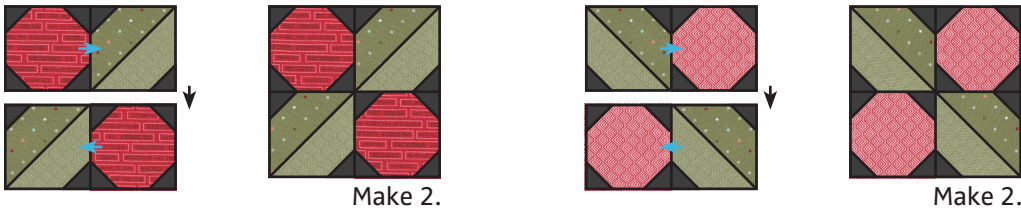

Row Assembly:

Assemble Row.

Holly Row should measure $6\frac{1}{2}$ " x $33\frac{1}{2}$ ".

