

All the Trimmings

MYSTERY QUILT ALONG

FAT QUARTER SHOP EXCLUSIVE

Week Four - Tree Row:

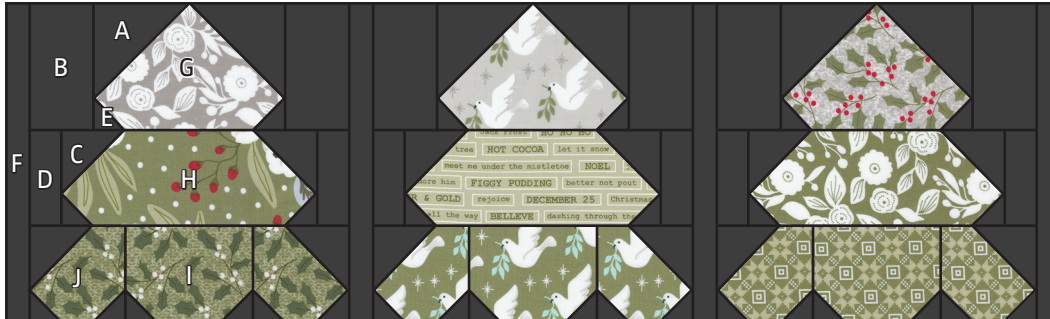

Unfinished size: 10 1/2" x 33 1/2"

Cutting:

Background 9900-118 	A	6 - 3 1/2" squares
	B	6 - 2 1/2" x 4 1/2" rectangles
	C	12 - 2 1/2" squares
	D	6 - 1 1/2" x 3 1/2" rectangles
	E	30 - 1 1/2" squares
	F	4 - 1 1/4" x 10 1/2" rectangles
Top Tree Print 3 LC Squares 	G	1 - 4 1/2" x 6 1/2" rectangle (3 total)
Middle Tree Print 3 LC Squares 	H	1 - 3 1/2" x 8 1/2" rectangle (3 total)
Bottom Tree Print 3 LC Squares 	I	1 - 3 1/2" x 4 1/2" rectangles (3 total)
	J	2 - 3 1/2" squares (6 total)

LC = Layer Cake Square

Use 1/4" seams and press as arrows indicate throughout.

Block Assembly:

Draw a diagonal line on the wrong side of the Fabric A squares.

With right sides facing, layer a Fabric A square on the top left corner of a Fabric G rectangle.

Stitch on the drawn line and trim 1/4" away from the seam.



Repeat on the top right corner.

Partial Top Tree Unit should measure 4 1/2" x 6 1/2".



Make 1.



Make 1.

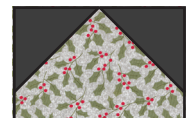

Make 1.

TO FIND THE KIT, PATTERNS & MORE!

WWW.FATQUARTERSHOP.COM/SEW-ALONGS/ALL-THE-TRIMMINGS

#AllTheTrimmingsQAL

WWW.FATQUARTERSHOP.COM



All the Trimmings

MYSTERY QUILT ALONG

FAT QUARTER SHOP EXCLUSIVE

Draw a diagonal line on the wrong side of the Fabric E squares.

With right sides facing, layer a Fabric E square on the bottom left corner of a Partial Top Tree Unit.

Stitch on the drawn line and trim 1/4" away from the seam.



Repeat on the bottom right corner.

Top Tree Unit should measure 4 1/2" x 6 1/2".



Make 1.



Make 1.

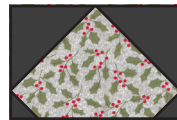

Make 1.

Assemble two Fabric B rectangles and one Top Tree Unit.

First Tree Unit should measure 4 1/2" x 10 1/2".



Make 1.



Make 1.

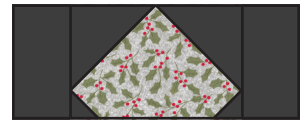

Make 1.

Draw a diagonal line on the wrong side of the Fabric C squares.

With right sides facing, layer a Fabric C square on the top left corner of a Fabric H rectangle.

Stitch on the drawn line and trim 1/4" away from the seam.



Repeat on the top right corner.

Partial Middle Tree Unit should measure 3 1/2" x 8 1/2".



Make 1.



Make 1.



Make 1.

All the Trimmings

MYSTERY QUILT ALONG

FAT QUARTER SHOP EXCLUSIVE

With right sides facing, layer a Fabric E square on the bottom left corner of a Partial Middle Tree Unit. Stitch on the drawn line and trim 1/4" away from the seam.



Repeat on the bottom right corner.

Middle Tree Unit should measure 3 1/2" x 8 1/2".



Assemble two Fabric D rectangles and one Middle Tree Unit.

Second Tree Unit should measure 3 1/2" x 10 1/2".

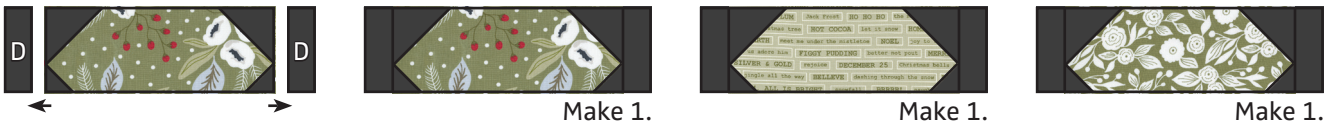

With right sides facing, layer a Fabric C square on the top left corner of a Fabric J square.

Stitch on the drawn line and trim 1/4" away from the seam.



Repeat on the bottom corners with two Fabric E squares.

Left Corner Unit should measure 3 1/2" x 3 1/2".



With right sides facing, layer a Fabric C square on the top right corner of a Fabric J square.

Stitch on the drawn line and trim 1/4" away from the seam.



Repeat on the bottom corners with two Fabric E squares.

Right Corner Unit should measure 3 1/2" x 3 1/2".



All the Trimmings

MYSTERY QUILT ALONG

FAT QUARTER SHOP EXCLUSIVE

With right sides facing, layer a Fabric E square on the bottom left corner of a Fabric I square.
Stitch on the drawn line and trim $\frac{1}{4}$ " away from the seam.



Repeat on the bottom right corner.

Center Unit should measure $3\frac{1}{2}$ " x $4\frac{1}{2}$ ".

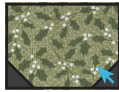

Make 1.



Make 1.



Make 1.

Assemble one Left Corner Unit, one matching Center Unit and one matching Right Corner Unit.

Bottom Tree Unit should measure $3\frac{1}{2}$ " x $10\frac{1}{2}$ ".

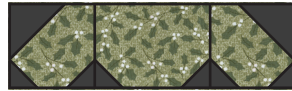
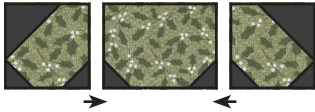

Make 1.



Make 1.



Make 1.

Assemble Block.

Tree Block should measure $10\frac{1}{2}$ " x $10\frac{1}{2}$ ".

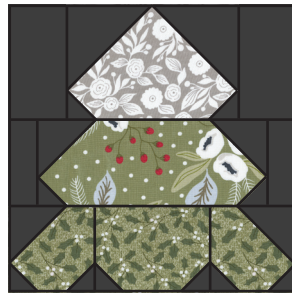
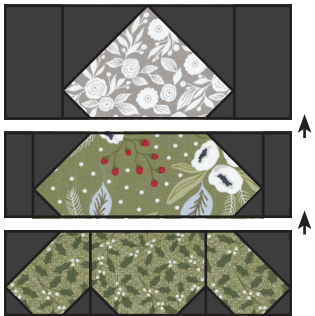

Make 1.

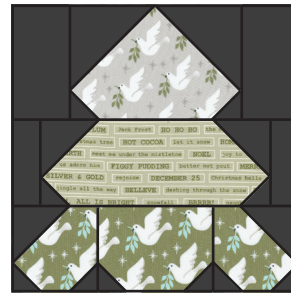

Make 1.

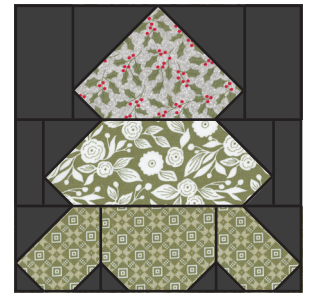

Make 1.

All the Trimmings

MYSTERY QUILT ALONG

FAT QUARTER SHOP EXCLUSIVE

Row Assembly:

Assemble Row.

Tree Row should measure 10 1/2" x 33 1/2".

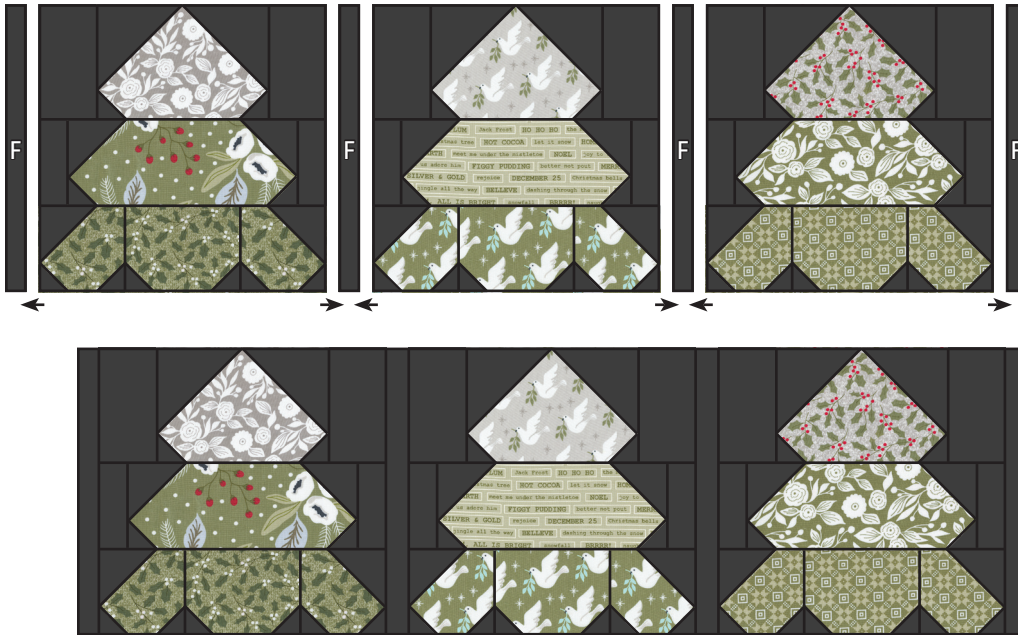

Make 1.

Notes