



Mini Quilt:
24 1/2" x 27 1/2"



Crib Quilt:
36 1/2" x 42 1/2"



Lap Quilt:
48 1/2" x 57 1/2"

Collection used:
Starlight Gatherings by
Primitive Gatherings for
Moda Fabrics

Fabric Requirements:

	Mini (3" Block)	Crib (6" Block)	Lap (9" Block)
Light Prints	10 - 10" squares	10 - Fat Quarters	10 - Fat Quarters
Dark Prints	10 - 10" squares	10 - Fat Quarters	10 - Fat Quarters
Inner Border	1/4 yard	1/3 yard	3/8 yard
Middle Border	1/3 yard	1/2 yard	1/2 yard
Outer Border	5/8 yard	5/8 yard	3/4 yard
Binding	1/2 yard	1/2 yard	5/8 yard
Backing	1 yard	2 5/8 yards	3 1/4 yards

Follow the cutting and block assembly instructions in the Sewcialites #2 Loyal Block Pattern for your blocks. To recreate the Blue and Cream quilt, pair your fabrics into ten sets of one light and one dark print. Make two blocks from each set. In the first block, you will use the light prints as the background and in the second block the dark will serve as the background.

<https://www.fatquartershop.com/sewcialites-block-two-loyal-free-pdf>

Finishing Cutting:

	Mini (3" Block)	Crib (6" Block)	Lap (9" Block)
Inner Border	2 - 1 1/2" x 15 1/2" strips (D1) 2 - 1 1/2" x 14 1/2" strips (D2)	2 - 1 1/2" x 30 1/2" strips (D1) 2 - 1 1/2" x 26 1/2" strips (D2)	3 - 1 1/2" x WOF strips (D1) 2 - 1 1/2" x 38 1/2" strips (D2)
Middle Border	2 - 2 1/2" x 17 1/2" strips (E1) 2 - 2 1/2" x 18 1/2" strips (E2)	2 - 2 1/2" x 32 1/2" strips (E1) 2 - 2 1/2" x 30 1/2" strips (E2)	5 - 2 1/2" x WOF strips (E)
Outer Border	2 - 3 1/2" x 21 1/2" strips (F1) 2 - 3 1/2" x 24 1/2" strips (F2)	2 - 3 1/2" x 36 1/2" strips (F1) 2 - 3 1/2" x 36 1/2" strips (F2)	6 - 3 1/2" x WOF strips (F)
Binding	4 - 2 1/2" x WOF strips (G)	5 - 2 1/2" x WOF strips (G)	6 - 2 1/2" x WOF strips (G)







WOF = width of fabric

Copyright 2021 Fat Quarter Shop, LLC. All rights reserved. Duplication of any kind is prohibited.

This pattern may be used for personal purposes only and may not be reproduced without the express written permission from the Fat Quarter Shop.

These patterns may not be used for commercial purposes.



Mini Quilt:		Crib Quilt:		Lap Quilt:	
					
Make 10 - 3 1/2" blocks.	Make 10 - 3 1/2" blocks.	Make 10 - 6 1/2" blocks.	Make 10 - 6 1/2" blocks.	Make 10 - 9 1/2" blocks.	Make 10 - 9 1/2" blocks.

Quilt Center:

Assemble Quilt Center. Pay close attention to block placement. Press rows in opposite directions.

Quilt Center should measure:

Mini: 12 1/2" x 15 1/2"

Crib: 24 1/2" x 30 1/2"

Lap: 36 1/2" x 45 1/2"

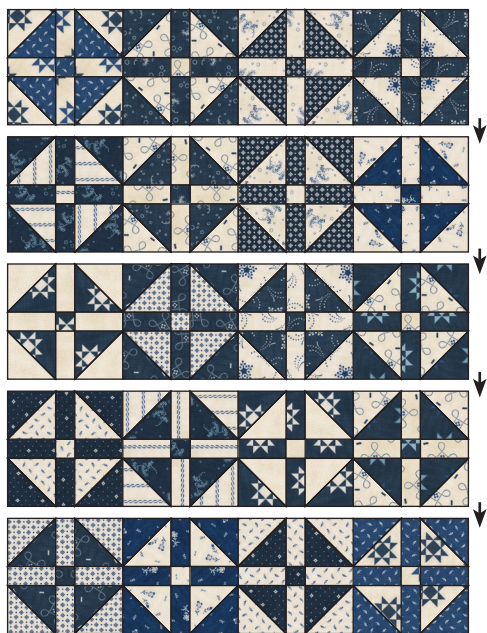

Borders pictured below are for the Crib Quilt. Border diagrams are not proportional for the other sizes.

Inner Borders:

Lap Quilt: Sew the Fabric D1 strips end to end and subcut into:

2 - 1 1/2" x 45 1/2" strips (D1)

Attach side inner borders using the Fabric D1 strips.

Attach top and bottom inner borders using the Fabric D2 strips.

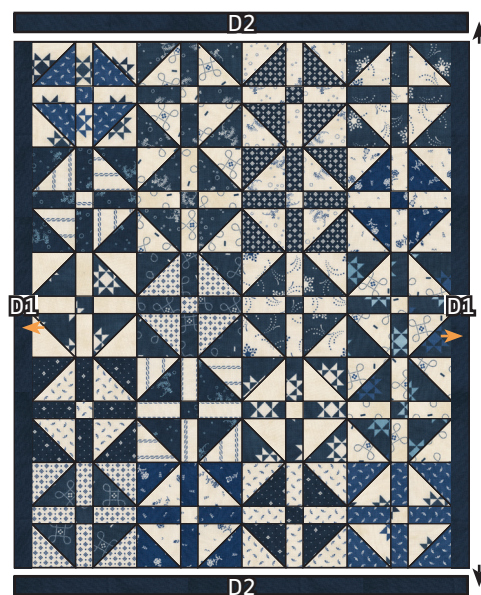

Middle Borders:

Lap Quilt: Sew the Fabric E strips end to end and subcut into:

2 - 2 1/2" x 47 1/2" strips (E1)

2 - 2 1/2" x 42 1/2" strips (E2)

Attach side middle borders using the Fabric E1 strips.

Attach top and bottom middle borders using the Fabric E2 strips.

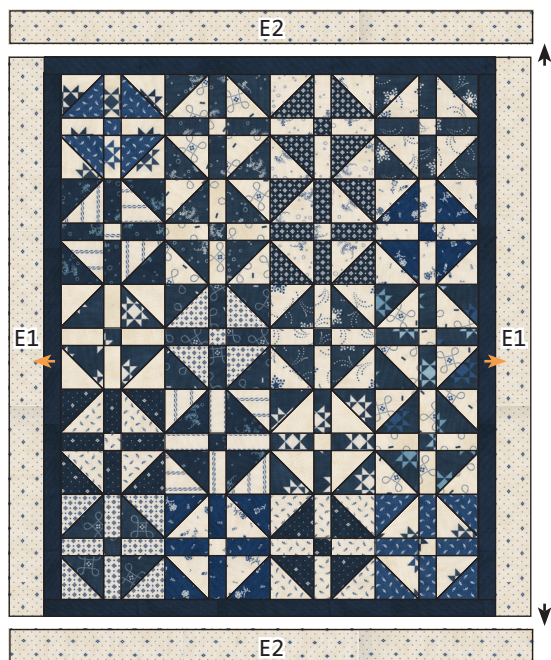

Outer Borders:

Lap Quilt: Sew the Fabric F strips end to end and subcut into:

2 - 3 1/2" x 51 1/2" strips (F1)

2 - 3 1/2" x 48 1/2" strips (F2)

Attach side outer borders using the Fabric F1 strips.

Attach top and bottom outer borders using the Fabric F2 strips.

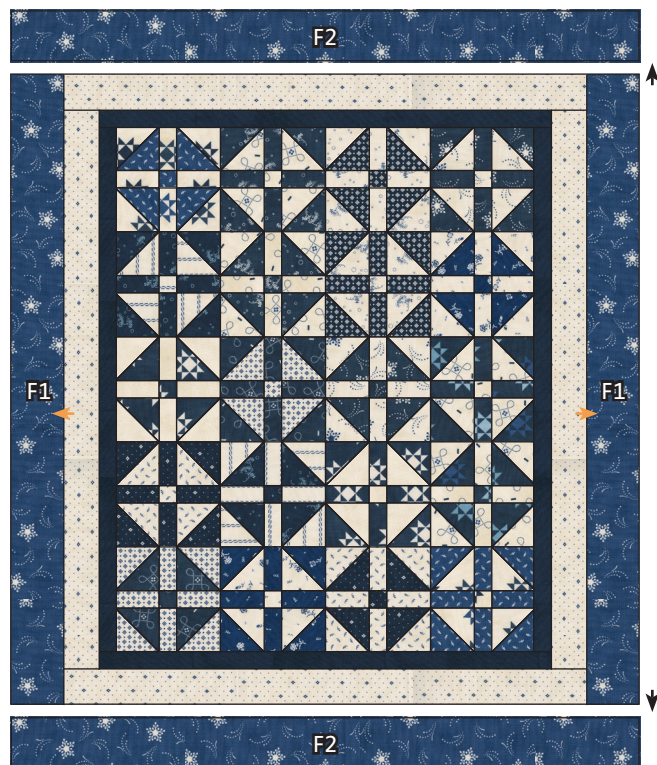

Binding:

Piece the Fabric G strips end to end.

Quilt and bind as desired.