

Christmastime

MYSTERY QUILT ALONG

Week Four: Wrapped With Cheer

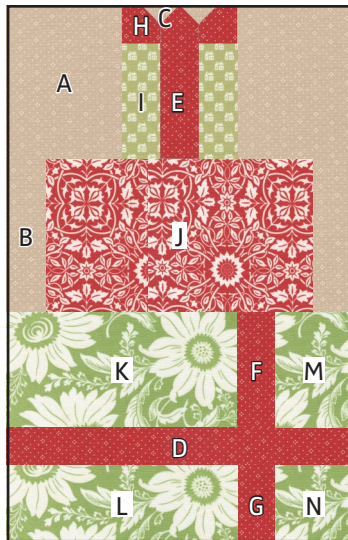

Unfinished size: 9 1/2" x 14 1/2"
Make 1.

Middle Gift Print 20446-14		J	1 - 4 1/2" x 7 1/2" rectangle
Large Gift Print 20440-12		K	1 - 3 1/2" x 6 1/2" rectangle
		L	1 - 2 1/2" x 6 1/2" rectangle
		M	1 - 2 1/2" x 3 1/2" rectangle
		N	1 - 2 1/2" square

Watch our tutorials on **You Tube**
[youtube.com/fatquartershop](https://www.youtube.com/fatquartershop)

Cutting:

Background 20457-16		A	2 - 3 1/2" x 4 1/2" rectangles
		B	2 - 1 1/2" x 4 1/2" rectangles
		C	4 - 1" squares
Ribbon Print 20457-14		D	1 - 1 1/2" x 9 1/2" rectangle
		E	1 - 1 1/2" x 4 1/2" rectangle
		F	1 - 1 1/2" x 3 1/2" rectangle
		G	1 - 1 1/2" x 2 1/2" rectangle
		H	2 - 1 1/2" squares
Small Gift Print 20447-13		I	2 - 1 1/2" x 3 1/2" rectangles



Use 1/4" seams and press as arrows indicate throughout.

Block Assembly:

Draw a diagonal line on the wrong side of the Fabric C squares.

With right sides facing, layer a Fabric C square on the top right corner of a Fabric H square.

Stitch on the drawn line and trim 1/4" away from the seam.

Partial Bow Unit should measure 1 1/2" x 1 1/2".



Make 2.

#CHRISTMASTIMEQAL

WWW.FATQUARTERSHOP.COM



& Christmastime &

MYSTERY QUILT ALONG

Assemble one Partial Bow Unit and one Fabric I rectangle.

Left Bow Unit should measure $1\frac{1}{2}'' \times 4\frac{1}{2}''$.

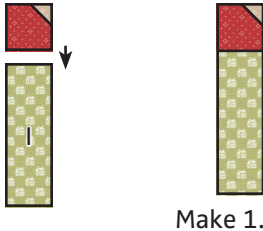

Assemble one Partial Bow Unit and one Fabric I rectangle.

Right Bow Unit should measure $1\frac{1}{2}'' \times 4\frac{1}{2}''$.

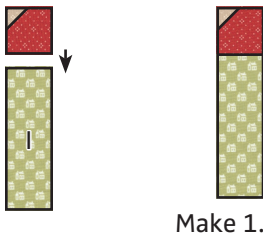

With right sides facing, layer a Fabric C square on the top left corner of the Fabric E rectangle.

Stitch on the drawn line and trim $\frac{1}{4}''$ away from the seam.

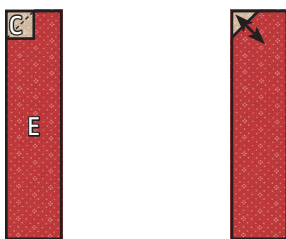

Repeat on the top right corner.

Middle Bow Unit should measure $1\frac{1}{2}'' \times 4\frac{1}{2}''$.

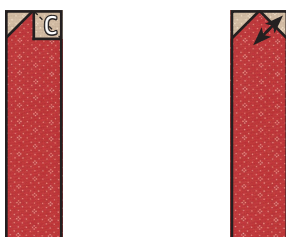

Assemble Unit.

Small Gift Unit should measure $4\frac{1}{2}'' \times 9\frac{1}{2}''$.

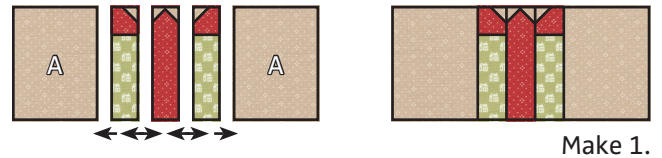

Assemble Unit.

Medium Gift Unit should measure $4\frac{1}{2}'' \times 9\frac{1}{2}''$.

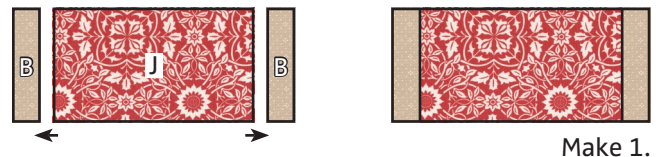

Assemble Unit.

Large Gift Unit should measure $6\frac{1}{2}'' \times 9\frac{1}{2}''$.

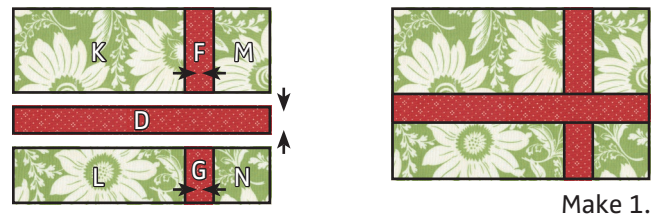

Assemble Block.

Wrapped With Cheer Block should measure $9\frac{1}{2}'' \times 14\frac{1}{2}''$.

