

MYSTERY

FAT QUARTER SHOP
EXCLUSIVE

Evergreen

QUILT ALONG

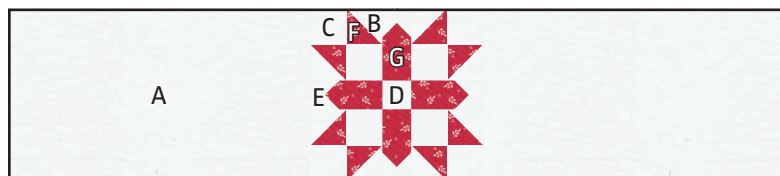

WEEK FOUR — Christmas Star Row:



Unfinished size: 6 1/2" x 27 1/2"

Make 1.

Cutting:

Background  37655-31	A	2 - 6 1/2" x 11" rectangles
	B	4 - 2 1/4" squares Δ
	C	8 - 1 3/4" squares
	D	1 - 1 1/2" square
	E	8 - 1 1/2" squares
Star Print  37651-13	F	4 - 2 1/4" squares Δ
	G	4 - 1 1/2" x 3" rectangles

Optional:

Δ 1.25" Half Square Triangle Paper by Triangles on a Roll
#H125



Use 1/4" seams and press as arrows indicate throughout.

Row Assembly:

Draw a diagonal line on the wrong side of the Fabric B squares.

With right sides facing, layer a Fabric B square with a Fabric F square.

Stitch 1/4" from each side of the drawn line.

Cut apart on the marked line.

Trim Half Square Triangle Unit to measure 1 3/4" x 1 3/4".



Make 8.

Assemble two Fabric C squares and two Half Square Triangle Units.

Corner Unit should measure 3" x 3".



Make 4.

Watch our tutorials on **YouTube**
youtube.com/fatquartershop

#EVERGREENMYSTERYQAL

WWW.FATQUARTERSHOP.COM



Draw a diagonal line on the wrong side of the Fabric E squares.

With right sides facing, layer a Fabric E square on the top left corner of a Fabric G rectangle.

Stitch on the drawn line and trim $\frac{1}{4}$ " away from the seam.



Repeat on the top right corner.

Star Point Unit should measure $1\frac{1}{2}$ " x 3".



Make 4.

Assemble two Corner Units and one Star Point Unit.

Outer Unit should measure 3" x $6\frac{1}{2}$ ".



Make 2.

Assemble two Star Point Units and the Fabric D square.

Center Unit should measure $1\frac{1}{2}$ " x $6\frac{1}{2}$ ".



Make 1.

Assemble Unit.

Christmas Star Unit should measure $6\frac{1}{2}$ " x $6\frac{1}{2}$ ".

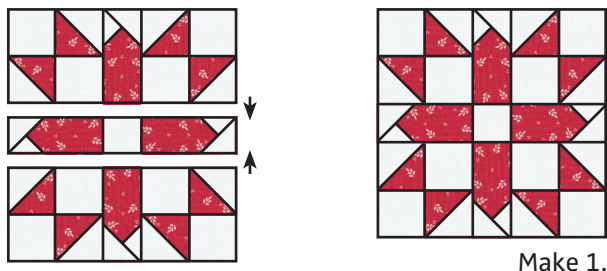

Make 1.

Assemble Row.

Christmas Star Row should measure $6\frac{1}{2}$ " x $27\frac{1}{2}$ ".

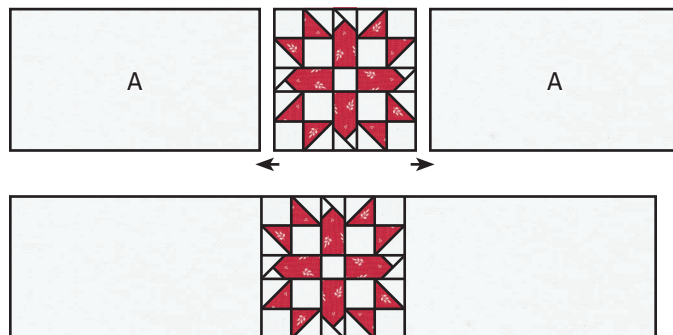

Make 1.