









snapshots QUILT ALONG

Block Two
Sew On & Sew On
12 1/2" x 16 1/2"

You can help by donating to St. Jude Children's Research Hospital®: www.FatQuarterShop.com/Snapshots

Snapshots Quilt Along Quilt Kits available.

Cutting:

A	1 - 4 1/4" x 4 1/2" rectangle	
B	1 - 2 1/2" square	55105-14
C	1 - 2" x 9 1/2" rectangle	
D	1 - 2" x 9 1/2" rectangle	
E	1 - 2" square	
F	2 - 1 1/2" x 12 1/2" rectangles	
G	1 - 1 1/2" x 4 1/2" rectangle	
H	1 - 1 1/2" x 4" rectangle	
I	1 - 1 1/2" x 3" rectangle	
J	1 - 1 1/2" x 2 1/2" rectangle	
K	1 - 1" x 1 1/2" rectangle	
L	1 - 1 1/2" x 2" rectangle	
M	1 - 1 1/2" x 6 1/4" rectangle (fussy cut)	
N	1 - 3 1/2" x 11" rectangle	55102-19
O	1 - 3 1/4" x 4" rectangle	55103-14
P	1 - 2 1/2" x 3" rectangle	55105-12
Q	1 - 2" x 3 1/4" rectangle	
R	1 - 1 3/4" x 2 1/2" rectangle	
S	1 - 1 1/2" x 8" rectangle	
T	1 - 1 1/2" x 4 1/4" rectangle	
U	1 - 1 1/2" x 3 3/4" rectangle	
V	1 - 1 1/2" x 3 1/2" rectangle	
W	1 - 1 1/2" x 3 1/2" rectangle	
X	1 - 1 1/2" x 2 1/2" rectangle	
Y	1 - 1 1/2" square	
Z	1 - 1 1/4" x 9 1/2" rectangle	
1	1 - 1 1/4" x 4 1/4" rectangle	
2	1 - 2 3/4" x 4 1/4" rectangle	
3	1 - 1 1/2" x 6 1/4" rectangle	 55108-11
4	1 - 1 1/2" x 2 1/2" rectangle	
5	1 - 1 1/2" x 3" rectangle	 55108-17
6	1 - 1" x 1 1/2" rectangle	

Use 1/4" seams and press as arrows indicate throughout.

Assemble the Fabric C rectangle, the Fabric L rectangle and the Fabric E square.

Top Sewing Machine Unit should measure 2" x 12".

Make one.

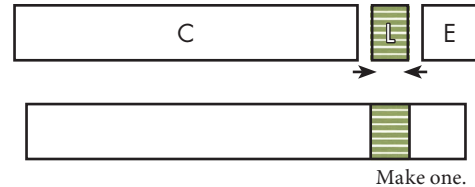

Assemble the Fabric R rectangle, the Fabric 4 rectangle and the Fabric X rectangle.

Pay close attention to the direction of the words.

Right Top Middle Sewing Machine Unit should measure 2 1/2" x 3 3/4".

Make one.



Assemble the Fabric M rectangle, the Fabric 3 rectangle and the Right Top Middle Sewing Machine Unit.

Partial Top Middle Sewing Machine Unit should measure 2 1/2" x 9 1/2".

Make one.

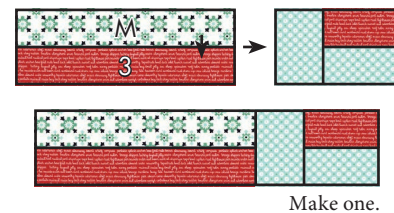

1-866-826-2069

www.FatQuarterShop.com

www.YouTube.com/FatQuarterShop

snapshots

QUILT ALONG

Block Two 12 1/2" x 16 1/2"
Sew On & Sew On

You can help by donating to St. Jude Children's Research Hospital®: www.FatQuarterShop.com/Snapshots

Assemble the Fabric Q rectangle, the Fabric Z rectangle and the Partial Top Middle Sewing Machine Unit.

Top Middle Sewing Machine Unit should measure 3 1/4" x 11".

Make one.

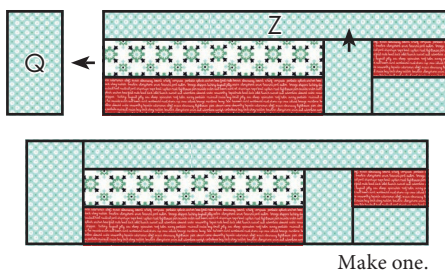

Draw a diagonal line on the wrong side of the Fabric B square.

With right sides facing, layer the Fabric B square on the bottom right corner of the Fabric O rectangle.

Stitch on the drawn line and trim 1/4" away from the seam.

Partial Left Bottom Middle Sewing Machine Unit should measure 3 1/4" x 4".

Make one.

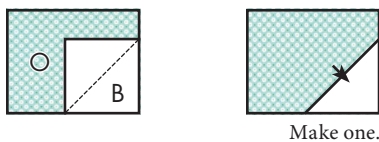

Assemble the Fabric K rectangle, the Fabric 6 rectangle and the Fabric I rectangle.

Pay close attention to the direction of the words.

Needle Unit should measure 1 1/2" x 4".

Make one.



Assemble the Partial Left Bottom Middle Sewing Machine Unit, the Needle Unit and the Fabric H rectangle.

Left Bottom Middle Sewing Machine Unit should measure 4" x 5 1/4".

Make one.

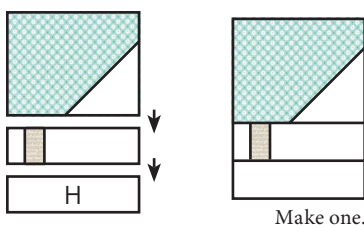

Draw a diagonal line on the wrong side of the Fabric Y square.

With right sides facing, layer the Fabric Y square on the top right corner of the Fabric A rectangle.

Stitch on the drawn line and trim 1/4" away from the seam.

Partial Center Bottom Middle Sewing Machine Unit should measure 4 1/4" x 4 1/2".

Make one.

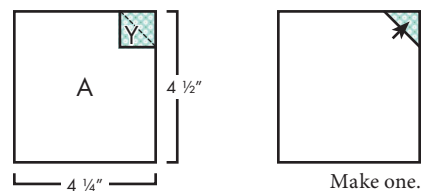

Assemble the Fabric 1 rectangle and the Partial Center Bottom Middle Sewing Machine Unit.

Center Bottom Middle Sewing Machine Unit should measure 4 1/4" x 5 1/4".

Make one.

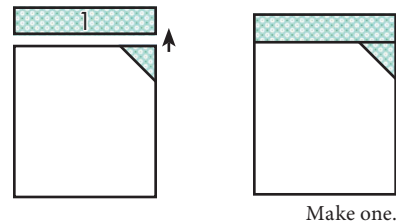

Assemble the Fabric U rectangle, the Fabric T rectangle and the Fabric 2 rectangle.

Pay close attention to the direction of the words.

Right Bottom Middle Sewing Machine Unit should measure 3 3/4" x 5 1/4".

Make one.

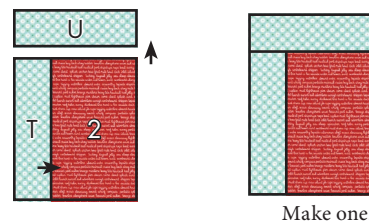

snapshots

QUILT ALONG

Block Two 12 1/2" x 16 1/2"
Sew On & Sew On

You can help by donating to St. Jude Children's Research Hospital®: www.FatQuarterShop.com/Snapshots

Assemble the Left Bottom Middle Sewing Machine Unit, the Center Bottom Middle Sewing Machine Unit and the Right Bottom Middle Sewing Machine Unit.

Bottom Middle Sewing Machine Unit should measure 5 1/4" x 11".

Make one.

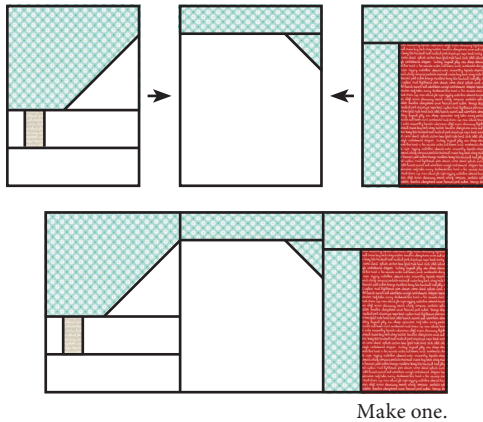

Assemble the Top Middle Sewing Machine Unit, the Bottom Middle Sewing Machine Unit and the Fabric S rectangle.

Partial Middle Sewing Machine Unit should measure 8" x 12".

Make one.

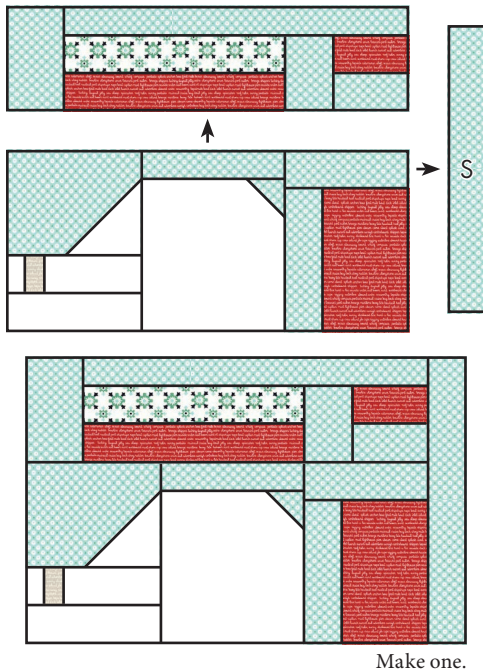

Assemble the Top Sewing Machine Unit and the Partial Middle Sewing Machine Unit.

Middle Sewing Machine Unit should measure 9 1/2" x 12".

Make one.

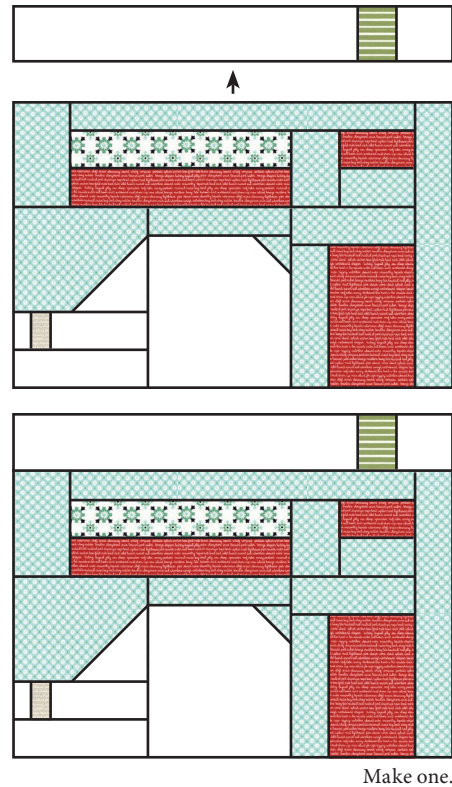

Assemble the Fabric J rectangle, the Fabric V rectangle and the Fabric G rectangle.

Right Sewing Machine Unit should measure 1 1/2" x 9 1/2".

Make one.

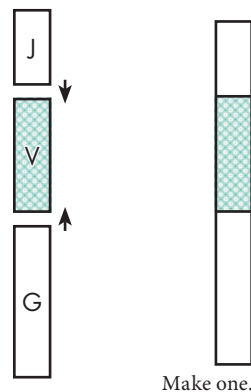

snapshots

QUILT ALONG

Block Two 12 1/2" x 16 1/2"
Sew On & Sew On

You can help by donating to St. Jude Children's Research Hospital®: www.FatQuarterShop.com/Snapshots

Assemble the Fabric D rectangle, the Middle Sewing Machine Unit and the Right Sewing Machine Unit.

Partial Sewing Machine Unit should measure 9 1/2" x 14 1/2".

Make one.

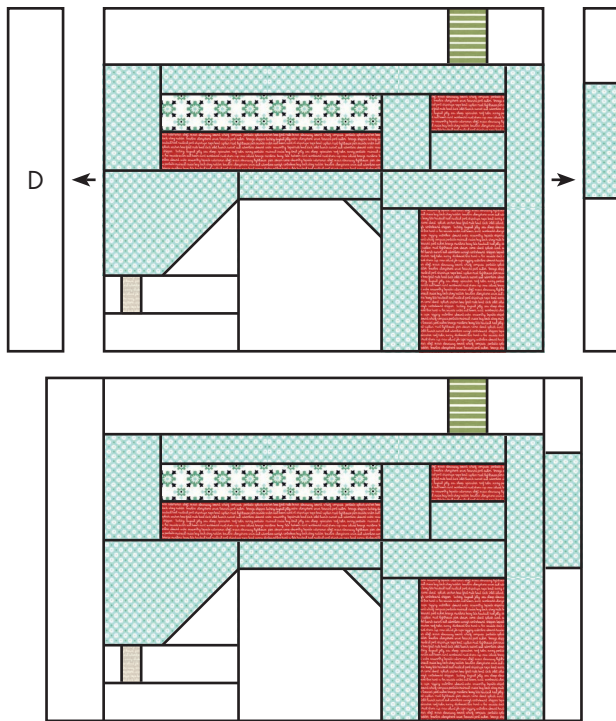

Make one.

Assemble the Fabric W rectangle, the Fabric 5 rectangle, the Fabric P rectangle and the Fabric N rectangle.

Pay close attention to the direction of the words.

Bottom Sewing Machine Unit should measure 3 1/2" x 14 1/2".

Make one.

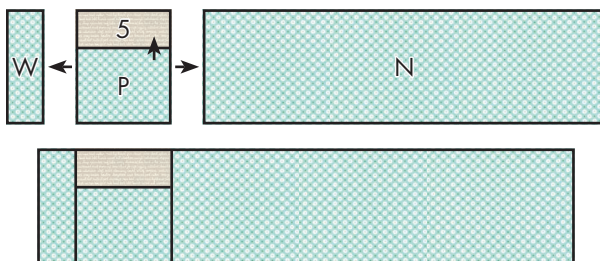

Make one.

Assemble the Sew On & Sew On Block.

Sew On & Sew On Block should measure 12 1/2" x 16 1/2".

