



Wishes Quilt Along Block Six - Susannah



Cutting:

- A 1 7 1/2" square
- B 4 4" squares
- C 1 4" square (from each Fabric C)
- D 2 4" squares (from each Fabric D)

Use 1/4" seams and press as arrows indicate throughout.

Draw a diagonal line on the wrong side of the Fabric C squares. With right sides facing, layer a Fabric C square on one corner of a Fabric A square.

Stitch on the drawn line and trim 1/4" away from the seam.

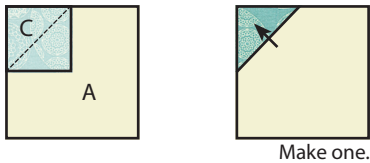

Repeat on the remaining corners of the Fabric A square.

Pay close attention to Fabric C placement.

Fabric C/A Unit should measure 7 1/2" x 7 1/2".



Assemble two Fabric D squares as shown.

Fabric D/D Unit should measure 4" x 7 1/2".

Make four total.

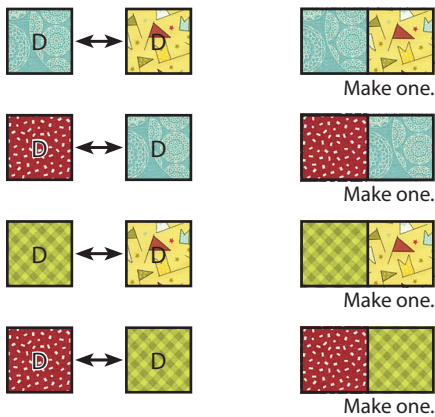

Assemble two Fabric B squares and two Fabric D/D Units as shown.

Outer Susannah Unit should measure 4" x 14 1/2".

Make two total.

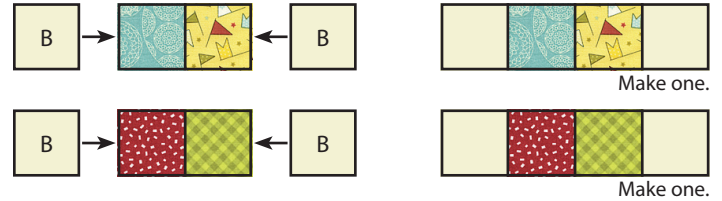

Assemble two Fabric D/D Units and the Fabric C/A Unit as shown.

Inner Susannah Unit should measure 7 1/2" x 14 1/2".

Make one.

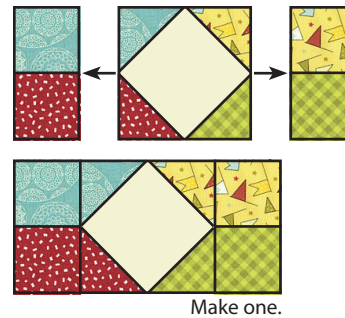

Assemble Block Six as shown.

Block Six should measure 14 1/2" x 14 1/2".

Make one.

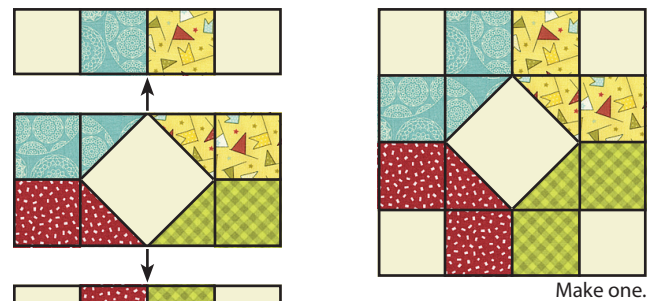

MAKE-A-WISH

Central & South Texas

You can help by donating to Make-A-Wish through the [Wishes Quilt Along donation page](#).



1-866-826-2069

www.FatQuarterShop.com

www.YouTube.com/FatQuarterShop