

SAMPLER QUILT

Part 1

Designed by Kim Diehl

Finished quilt size: 28½" x 28½"



Sew all pieces with right sides together and a ¼" seam allowance unless otherwise noted. For complete "How to Quilt" instructions, please visit shopmartingale.com/howtoquilt. Use your favorite technique for the appliqué portions of this sampler quilt, or refer to any of Kim's "Simple" series of books for her easy invisible machine-appliqué method.

MATERIALS

FOR ONE COMPLETE SAMPLER QUILT

- 2 fat quarters (18" x 22") of assorted neutral prints
- 5 fat eighths (9" x 22") of assorted neutral prints
- 20 chubby sixteenths (9" x 11") of assorted prints
- 20 charm squares (5" x 5") of assorted prints
- ½ yard of black print for sashing and binding
- 1 yard of fabric of your choice for backing
- 36" x 36" square of batting
- Bias bar to make ⅜"-wide stems
- Clover Quick Yo-Yo Maker, extra small
- Standard quilting supplies and supplies for your favorite appliqué method
- Liquid glue for fabric, water-soluble and acid-free (Quilter's Choice by Beacon Adhesives is Kim's favorite brand)

PROJECT NOTES

This little sampler quilt combines several of Kim's favorite blocks and elements from collections 1 and 2 of her Simple Whatnots Club, and is filled with a variety of prints, colors, and fun-to-stitch techniques. For easy-to-follow instructions, the components that make up this quilt have been divided into a four-part series of handouts.

This project is designed to be scrap-friendly and incorporate a wide range of fabrics, so specific prints haven't been noted in the materials list. The pictured quilt uses a mix of fabrics from Kim's Vintage Farmhouse and Heritage Hollow collections, but any combination of prints can be used — let your stash be your guide!

The blocks and units that make up the quilt center are assembled in three horizontal rows before the patchwork border is pieced and added. For greater ease, cutting instructions are provided as each portion of the quilt top is stitched and assembled. The pictured quilt can be referred to as you cut your fabrics, or you can create your own mix of colors and placement of prints to personalize the look of your quilt. Please be sure to cut all pieces across the width of the fabric in the order given unless otherwise noted.

IDAHO LILY BLOCK

FINISHED BLOCK SIZE:
8" x 8"

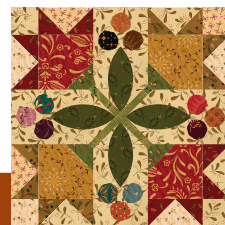

CUTTING

From assorted neutral prints, cut a combined total of:

- 8 rectangles, 1½" x 2½"
- 4 squares, 1½" x 1½"
- 2 rectangles, 2½" x 3½"
- 1 rectangle, 2½" x 8½"

From one red print and one gold print, cut:

- 2 squares, 2½" x 2½", from each print (combined total of 4)

From one coordinating red print and one coordinating gold print, cut:

- 8 squares, 1½" x 1½", from each print (combined total of 16)

From assorted green prints, cut:

- 4 matching print squares, 1½" x 1½"
- 2 matching print bias strips, 1¼" x 4"
- 4 matching print leaf appliques using the pattern on page 5

From assorted prints:

Use the Clover Quick Yo-Yo Maker to cut and prepare 12 yo-yos, following the manufacturer's instructions.

BLOCK ASSEMBLY

- 1 Use an acrylic ruler and pencil to draw a diagonal line on the wrong side of each red, gold, and green print 1½" square.
- 2 Layer a prepared green print square on one corner of a red print 2½" square. Stitch the pair together on the drawn line. Fold the resulting inner triangle open, aligning the corner with the corner of the red print square; press. Trim away the excess layers beneath the top triangle, leaving a ¼" seam allowance. Repeat with the remaining red and gold print 2½" squares to make a total of four flower base units.



Make 2 red and 2 gold.

- 3 Layer a prepared 1½" red square onto one end of a neutral 1½" x 2½" rectangle. Stitch, fold, press, and trim as instructed in step 2. Repeat with a second prepared 1½" red square to form a mirror-image point. Repeat for a total of four pieced red flying geese units and four pieced gold flying geese units measuring 1½" x 2½", including the seam allowances.

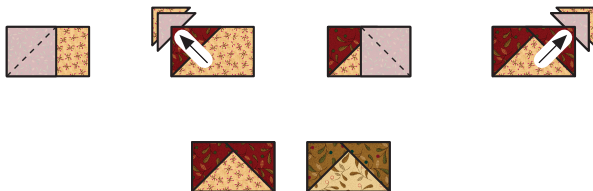

Make 4 red and 4 gold.

- 4 Referring to the illustration, lay out one red flower base unit, two red flying geese units, and one neutral print 1½" square in two horizontal rows. Join the pieces in each row. Press the seam allowances as shown. Join the rows. Press the seam allowances as shown. Repeat to make two red flower units and two gold flower units measuring 3½" square, including the seam allowances.

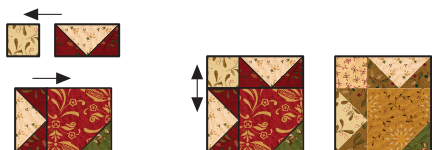

Make 2 red and 2 gold.

- 5 Referring to the illustration, lay out two red flower units, two gold flower units, two neutral 2½" x 3½" rectangles, and the neutral 2½" x 8½" rectangle. Join and press the pieces as shown to make one Idaho Lily block measuring 8½" square, including the seam allowances.

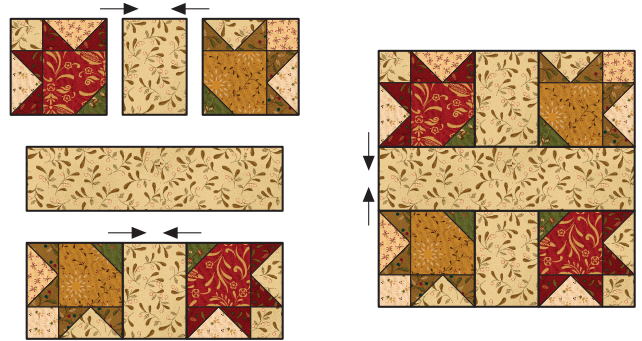

- 6 With wrong sides together, fold each green print bias strip in half lengthwise and use a scant ¼" seam allowance to stitch along the long raw edges. Use the bias bar to press each resulting stem flat, centering the seam allowances so they will be hidden from the front. Apply tiny dots of liquid fabric glue underneath the pressed seam of each stem at approximately ½" intervals. Use a hot, dry iron to heat set the seam allowances and anchor them in place.

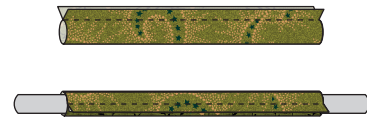

- 7 Fold the raw ends of the bias stems under, sizing the folds so that each stem will overlap onto the flower base approximately ¼" when positioned diagonally on the block as shown in the pictured block. Apply tiny dots of liquid glue or fabric glue stick underneath the folds at each end and use a hot, dry iron to heat set and anchor them in place. Dot the seam allowance of each prepared stem with liquid basting glue at approximately ½" intervals. Referring to the pictured block, position the stems on the block. From the back of the block, use a hot, dry iron to heat set the stems and anchor them in place.

- 8 Use your favorite method to appliqué the stems, four leaves, and 12 yo-yos to the block as shown.



HONEYCOMB BLOCK

FINISHED BLOCK SIZE: 4" x 8"



CUTTING

From assorted neutral prints, cut a *combined total of:*

8 squares, 2½" x 2½"

BLOCK ASSEMBLY

- Using the Honeycomb hexie pattern on page 5, use a pencil, acrylic ruler, and rotary cutter to trace and cut eight freezer paper pattern pieces exactly on the pattern lines; the seam allowances will be added later as you cut and prepare the shapes from fabric.
- Use the prepared freezer paper pattern pieces from step 1 and your favorite appliqué method to cut and prepare eight hexie appliqué from assorted prints. Reserve the prepared appliqué for later use, as the shapes will be appliqué to the background block after the quilt center has been assembled.
- Lay out the assorted neutral print 2½" squares in four rows of two squares. Join the squares in each horizontal row. Press the seam allowances open. Join the rows. Press the seam allowances open. The pieced Honeycomb background block should measure 4½" x 8½", including the seam allowances.

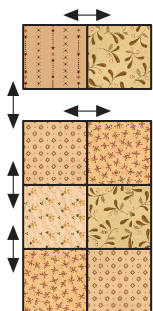

BARN STAR BLOCK

FINISHED BLOCK SIZE: 4" x 4"



CUTTING

From each of three assorted prints, cut a matching set of:
4 squares, 1½" x 1½" (combined total of 12)

From assorted prints, cut a *combined total of:*
24 squares, 1½" x 1½"

From assorted neutral prints, cut a *combined total of:*
12 squares, 1" x 1"
12 rectangles, 1½" x 2½"
12 squares, 1½" x 1½"

BLOCK ASSEMBLY

- Reserving the three matching sets of assorted print 1½" squares, use a pencil and an acrylic ruler to draw a diagonal sewing line on the wrong side of each neutral print 1" square and the remaining assorted print 1½" squares.
- Select a reserved set of 1½" squares. Layer a prepared neutral 1" square onto one corner of an assorted print 1½" square from the set. Stitch, press, and trim as instructed in step 2 of the Idaho Lily block instructions, page 2. Repeat for a total of four pieced squares measuring 1½" x 1½", including the seam allowances.



Make 4.

- Lay out the pieced squares from step 2 in two horizontal rows to form the star center unit. Join and press the pieces as shown.

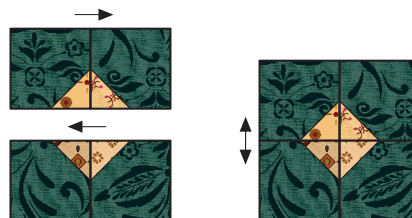

- Select eight prepared assorted print 1½" squares from step 1 and four assorted neutral print 1½" x 2½" rectangles. Referring to step 3 of the Idaho Lily block instructions on page 2, make four flying geese units measuring 1½" x 2½", including the seam allowances.

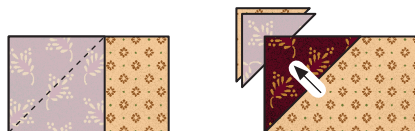

Make 4.

- Join a flying geese unit to the right and left sides of the star center unit to form star points; press as shown.

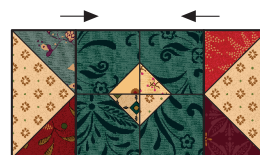

- 6 Join a neutral print $1\frac{1}{2}$ " square to each end of the remaining flying geese units; press as shown.



- 7 Join the step 6 pieced flying geese units to the remaining sides of the step 5 star center unit; press as shown.

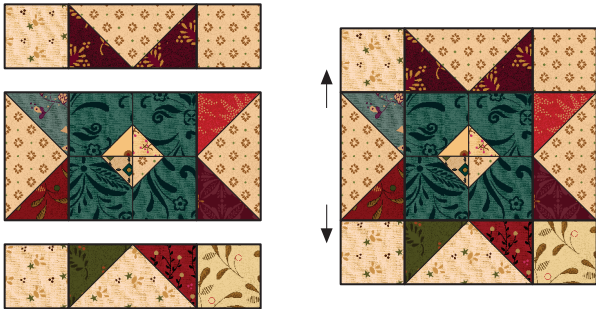

- 8 Repeat steps 2 through 7 to make a total of three Barn Star blocks measuring $4\frac{1}{2}$ " square, including the seam allowances. Do not join the blocks together at this time.

HEN PECKED BLOCK

FINISHED BLOCK SIZE: 4" x 4"



CUTTING

From assorted neutral prints, cut a **combined total of:** 8 squares, $1\frac{7}{8}$ " x $1\frac{7}{8}$ "; cut each square in half diagonally once to yield a total of 16 triangles. *Note: For a bit of the "make do" look, Kim substituted a handful of light assorted neutral print triangles in place of a few neutral print triangles, and adjusted the number of pieces to be cut accordingly.*

From assorted prints, cut a **combined total of:** 16 squares, $1\frac{7}{8}$ " x $1\frac{7}{8}$ "; cut each square in half diagonally *once* to yield a total of 32 triangles. (Please note that you'll only use one triangle from each print. If you'd like to be more frugal in your cutting, simply use 8 squares, cutting each one in half to yield the 16 needed triangles. Each print will be used twice and with this approach, you'll have no waste.)

BLOCK ASSEMBLY

- 1 Join an assorted print and a neutral print $1\frac{7}{8}$ " triangle along the long diagonal edges. Press the seam allowance away from the neutral print. Trim away the dog-ear points. Repeat for a total of 16 half-square-triangle units measuring $1\frac{1}{2}$ " square, including the seam allowances.



Make 16.

- 2 Select four half-square-triangle units from step 1. Join and press as shown. Repeat to make rows 1 and 3 of the Hen Pecked block.



- 3 Repeat step 2 to make rows 2 and 4 of the Hen Pecked block, pressing the seams in the opposite direction as shown.

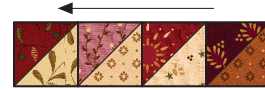

- 4 Referring to the pictured quilt, join the rows, alternating the even- and odd-numbered rows so the seams will nest together. Press the seam allowances of each row open. The pieced Hen Pecked block should measure $4\frac{1}{2}$ " square, including the seam allowances.

ASSEMBLING

ROW 1 OF THE QUILT CENTER

- 1 Using the pictured quilt as a guide, join the left edge of the pieced Honeycomb background unit to the right edge of the Idaho Lily block. Press the seam allowances toward the Honeycomb unit.
- 2 Lay out the three Barn Star blocks and the Hen Pecked block as shown. Join the pieces in each horizontal row. Press the seam allowances of the top row to the right. Press the seam allowances of the bottom row to the left, away from the Hen Pecked block. Join the rows. Press the seam allowances open.

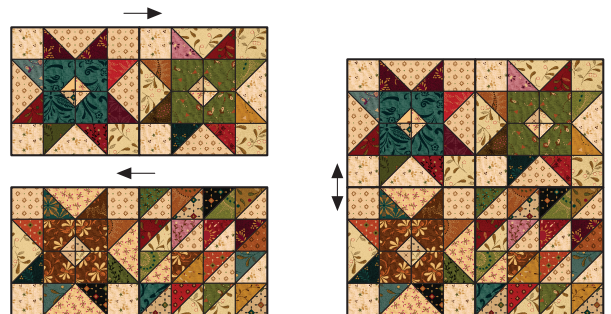

- 3 Referring to the pictured quilt, join the right edge of the Idaho Lily/Honeycomb unit from step 1 to the left edge of the Barn Stars/Hen Pecked unit from step 2. Press the seam allowances toward the Honeycomb unit. The pieced Row 1 unit should now measure $8\frac{1}{2}$ " x $20\frac{1}{2}$ ", including the seam allowances. Continue to reserve the Honeycomb hexie appliqués until the entire quilt center has been pieced.

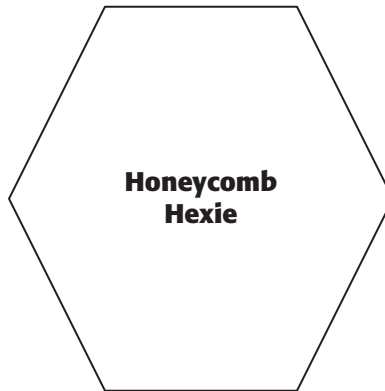
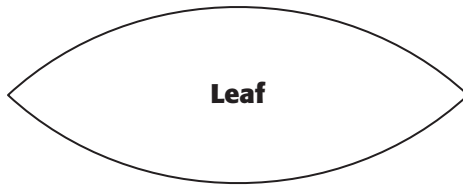

Patterns do not include seam allowances.



Turn off scaling when printing this page.
The box at left should measure 1/2" x 1/2".

SAMPLER QUILT

Part 2

Designed by Kim Diehl

Finished quilt size: 28½" x 28½"



Sew all pieces with right sides together and a ¼" seam allowance unless otherwise noted. For complete "How to Quilt" instructions, please visit shopmartingale.com/howtoquilt. Use your favorite technique for the appliqué portions of this sampler quilt, or refer to any of Kim's "Simple" series of books for her easy invisible machine-appliqué method.

MATERIALS

FOR ONE COMPLETE SAMPLER QUILT

- 2 fat quarters (18" x 22") of assorted neutral prints
- 5 fat eighths (9" x 22") of assorted neutral prints
- 20 chubby sixteenths (9" x 11") of assorted prints
- 20 charm squares (5" x 5") of assorted prints
- ½ yard of black print for sashing and binding
- 1 yard of fabric of your choice for backing
- 36" x 36" square of batting
- Bias bar to make ⅜"-wide stems
- Clover Quick Yo-Yo Maker, extra small
- Standard quilting supplies and supplies for your favorite appliqué method
- Liquid glue for fabric, water-soluble and acid-free (Quilter's Choice by Beacon Adhesives is Kim's favorite brand)

PROJECT NOTES

This little sampler quilt combines several of Kim's favorite blocks and elements from collections 1 and 2 of her Simple Whatnots Club, and is filled with a variety of prints, colors, and fun-to-stitch techniques. For easy-to-follow instructions, the components that make up this quilt have been divided into a four-part series of handouts.

This project is designed to be scrap-friendly and incorporate a wide range of fabrics, so specific prints haven't been noted in the materials list. The pictured quilt uses a mix of fabrics from Kim's Vintage Farmhouse and Heritage Hollow collections, but any combination of prints can be used — let your stash be your guide!

The blocks and units that make up the quilt center are assembled in three horizontal rows before the patchwork border is pieced and added. For greater ease, cutting instructions are provided as each portion of the quilt top is stitched and assembled. The pictured quilt can be referred to as you cut your fabrics, or you can create your own mix of colors and placement of prints to personalize the look of your quilt. Please be sure to cut all pieces across the width of the fabric in the order given unless otherwise noted.

LAUNDRY DAY CHECKERBOARD BLOCK

FINISHED BLOCK SIZE: 2" x 8"

CUTTING

From assorted prints, cut:
16 squares, 1½" x 1½"

BLOCK ASSEMBLY

Referring to the illustration, lay out the assorted print 1½" squares in two rows of eight squares. Join the squares in each horizontal row. Press the top row seam allowances to the right. Press the bottom row seam allowances to the left. Join the rows. Press the seam allowances open. The pieced checkerboard unit should measure 2½" x 8½", including the seam allowances.

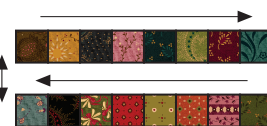

VILLAGE SQUARE CHURN DASH BLOCK

FINISHED BLOCK SIZE: 3" x 3"

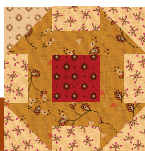

CUTTING

From assorted neutral prints, cut a *combined total of*:

8 rectangles, 1" x 1½"

4 squares, 1⅞" x 1⅞"; cut each square in half diagonally *once* to yield 2 triangles (combined total of 8)

1 rectangle, 1½" x 3½"

2 rectangles, 1" x 3½"

2 rectangles, 1" x 8½"

From *each of two* assorted prints, cut:

4 rectangles, 1" x 1½" (combined total of 8)

2 squares, 1⅞" x 1⅞" (combined total of 4); cut each square in half diagonally *once* to yield 2 triangles (combined total of 8)

Organize the pieces into two sets, grouping them together by print.

From one coordinating assorted print, cut:

2 squares, 1½" x 1½"

BLOCK AND UNIT ASSEMBLY

- 1 Select a matching set of patchwork pieces cut from one assorted print, one coordinating assorted print 1½" square, four assorted neutral print 1" x 1½" rectangles, and four assorted neutral print 1⅞" triangles.
- 2 Join an assorted print and a neutral print 1⅞" triangle along the long diagonal edges. Press the seam allowance away from the neutral print. Trim away the dog-ear points. Repeat for a total of four half-square-triangle units measuring 1½" square, including the seam allowances.



Make 4.

- 3 Join an assorted print and a neutral print 1" x 1½" rectangle along the long edges. Press the seam allowance toward the assorted print. Repeat for a total of four pieced squares.



Make 4.

- 4 Referring to the illustration, lay out four pieced half-square-triangle units from step 2, four pieced squares from step 3, and one coordinating print 1½" square. Join and press the pieces in each horizontal row as shown. Join the rows, pressing the seam allowances as shown.

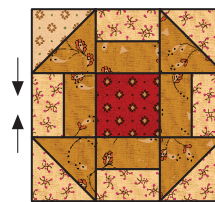
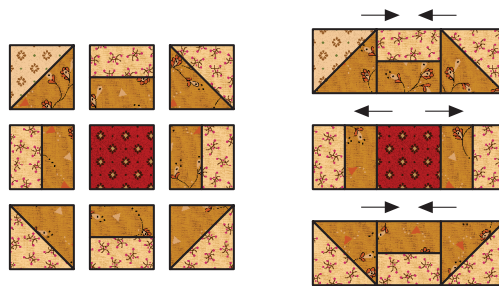

- 5 Repeat steps 1 through 4 to make a total of two pieced Churn Dash blocks measuring 3½" square, including the seam allowances.
- 6 Referring to the illustration, lay out the two pieced Churn Dash blocks, one assorted neutral print 1½" x 3½" rectangle, two assorted neutral print 1" x 3½" rectangles, and two assorted neutral 1" x 8½" rectangles. Join and press the pieces in the middle row as shown. Join the remaining neutral 1" x 8½" rectangles to the top and bottom edges of the Churn Dash unit. Press the seams away from the middle row. The pieced Churn Dash unit should now measure 4½" x 8½", including the seam allowances.

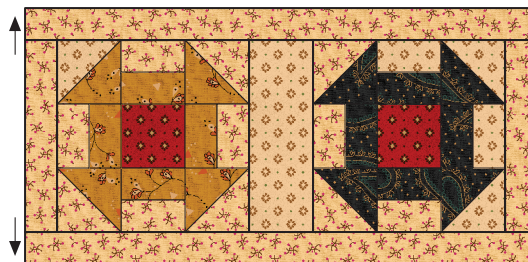
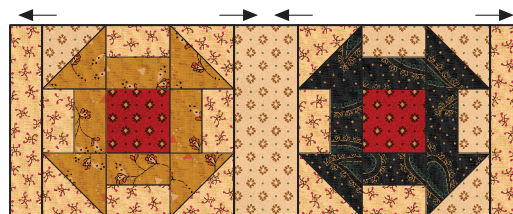

LAUNDRY DAY BLOCK

FINISHED BLOCK SIZE: 3" x 3"

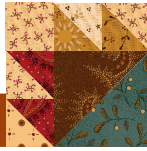

CUTTING

From assorted neutral prints, cut a **combined total of:**
8 squares, 1 7/8" x 1 7/8", cut each square in half diagonally
once to yield a total of 16 triangles.

4 squares, 1 1/2" x 1 1/2"

From assorted prints, cut a **combined total of:**

8 squares, 2 7/8" x 2 7/8"; cut each square in half diagonally
once to yield a total of 16 triangles (Please note that
you'll only use one triangle from each print. If you'd like
to be more frugal in your cutting, simply use 4 squares,
cutting each square in half to yield the 8 needed
triangles. Each print will be used twice and with this
approach, you'll have no waste.)

8 squares, 1 7/8" x 1 7/8"; cut each square in half diagonally
once to yield a total of 16 triangles. Keep the triangles
organized by print.

BLOCK AND UNIT ASSEMBLY

- 1 Select two assorted print large triangles. Join the pair
together along the long diagonal edges. Press the seam
allowances to one side. Trim away the dog-ear points.
Repeat for a total of four large half-square-triangle units
measuring 2 1/2" square, including the seam allowances.

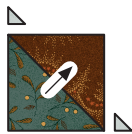

Make 4.

- 2 Using the small assorted print and assorted neutral
print triangles, repeat step 1 to make a total of 16 small
half-square-triangle units measuring 1 1/2" square,
including the seam allowances.



Make 16.

- 3 Select two small half-square-triangle units sewn from
the same assorted print. Referring to the illustration,
join and press. Repeat for a total of four pieced rectangle
units, and four pieced mirror-image rectangle units
measuring 1 1/2" x 2 1/2", including the seam allowances.



Make 4 of each.

- 4 Referring to the illustration, lay out a large half-square-
triangle unit from step 1, a small pieced rectangle unit
and a small pieced mirror-image rectangle unit from
step 3, and an assorted neutral print 1 1/2" square to form
a block. Join and press the pieces in each horizontal
row as shown. Join the rows. Press the seam allowances
open. Repeat for a total of four pieced blocks measuring
3 1/2" square, including the seam allowances.

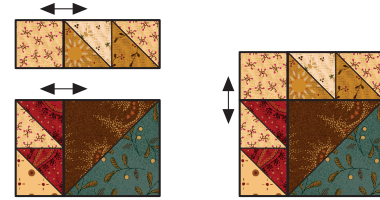

Make 4.

- 5 Referring to the illustration, lay out four pieced blocks
in two horizontal rows. Join and press the blocks in each
row as shown. Join the rows. Press the seam allowances
open. The pieced block unit should now measure 6 1/2"
square, including the seam allowances.

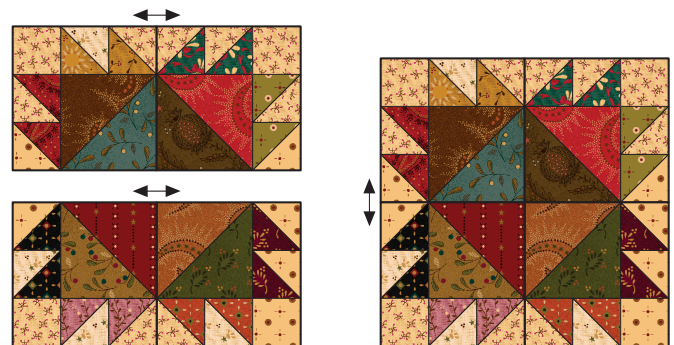

WIDDLYTINKS BLOCK

FINISHED BLOCK SIZE: 3" x 3"



CUTTING

From assorted neutral prints, cut a **combined total of:**
2 squares, 3 1/2" x 3 1/2"

From assorted prints, cut a **combined total of:**

8 leaf appliqués using the pattern provided on page 4
Use the Clover Quick Yo-Yo Maker to cut and prepare
2 yo-yos, following the manufacturer's instructions.

BLOCK ASSEMBLY

- 1 Fold each neutral print 3 1/2" square in half diagonally,
with right sides together, and use a hot, dry iron to
lightly press a diagonal crease. Refold and press a
second diagonal crease in each square to form an "x".

- Position a prepared yo-yo onto a prepared neutral square, placing it at the center of the square where the pressed creases intersect. Lay out four assorted print leaf appliqués, positioning them over the creases and tucking the inner points underneath the yo-yo. Pin or baste the leaves in place. Remove the yo-yo and use your favorite appliqué to stitch the leaves to the square. Reposition and stitch the yo-yo. Repeat for a total of two appliqué blocks.



- Referring to the pictured quilt, join the appliqué blocks to make an appliqué unit. Press the seam allowances open. The pieced and appliqué Widdlytinks unit should now measure $3\frac{1}{2}$ " x $6\frac{1}{2}$ ", including the seam allowances.

CLOUD NINE BLOCK

FINISHED BLOCK SIZE: 3" x 3"

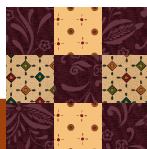

CUTTING

From *each* of two assorted neutral prints, cut:
4 squares, $1\frac{1}{2}$ " x $1\frac{1}{2}$ " (combined total of 8)

From *each* of two assorted prints, cut:
5 squares, $1\frac{1}{2}$ " x $1\frac{1}{2}$ " (combined total of 10)

BLOCK AND UNIT ASSEMBLY

- Select five squares cut from one assorted print, two squares cut from one neutral print, and two squares cut from a second neutral print. Lay out the squares as shown to form a Nine-Patch. Join and press the squares in each horizontal row as shown. Join and press the rows as shown. Repeat for a total of two pieced Nine-Patch blocks measuring $3\frac{1}{2}$ " square, including the seam allowances.

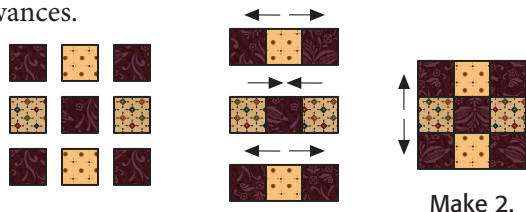

- Referring to the pictured quilt, join the two Nine-Patch blocks to make a pieced Nine-Patch unit. Press the seam allowances open. The pieced unit should now measure $3\frac{1}{2}$ " x $6\frac{1}{2}$ ", including the seam allowances.

ASSEMBLING

ROW 2 OF THE QUILT CENTER

- Using the pictured quilt as a guide, join the bottom edge of the Laundry Day Checkerboard block to the top edge of the Village Square Churn Dash unit. Press the seam allowances toward the Churn Dash unit.
- Referring to the pictured quilt, join the Laundry Day block and the Cloud Nine unit to the Widdlytinks unit. Press the seam allowances toward the Widdlytinks unit.
- Using the pictured quilt as a guide, join the right edge of the Checkerboard/Churn Dash unit from step 1 to the left edge of the Laundry Day/Widdlytinks/Cloud Nine unit from step 2. Press the seam allowances toward the Checkerboard/Churn Dash unit. The pieced Row 2 unit should now measure $6\frac{1}{2}$ " x $20\frac{1}{2}$ ", including the seam allowances.

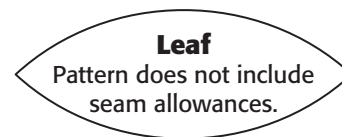

Turn off scaling when printing this page.
The box at left should measure $\frac{1}{2}$ " x $\frac{1}{2}$ ".

SAMPLER QUILT

Part 3

Designed by Kim Diehl

Finished quilt size: 28½" x 28½"



Sew all pieces with right sides together and a ¼" seam allowance unless otherwise noted. For complete "How to Quilt" instructions, please visit shopmartingale.com/howtoquilt. Use your favorite technique for the appliqué portions of this sampler quilt, or refer to any of Kim's "Simple" series of books for her easy invisible machine-appliqué method.

MATERIALS

FOR ONE COMPLETE SAMPLER QUILT

2 fat quarters (18" x 22") of assorted neutral prints
 5 fat eighths (9" x 22") of assorted neutral prints
 20 chubby sixteenths (9" x 11") of assorted prints
 20 charm squares (5" x 5") of assorted prints
 ½ yard of black print for sashing and binding
 1 yard of fabric of your choice for backing
 36" x 36" square of batting
 Bias bar to make ⅜"-wide stems
 Clover Quick Yo-Yo Maker, extra small
 Standard quilting supplies and supplies for your favorite appliqué method
 Liquid glue for fabric, water-soluble and acid-free (Quilter's Choice by Beacon Adhesives is Kim's favorite brand)

WINDOW BOX

PIANO KEY BLOCK

FINISHED BLOCK SIZE: 2" x 12"

CUTTING

From assorted prints, cut a combined total of:
 6 rectangles, 1½" x 2½"
 12 rectangles, 1" x 2½"

BLOCK ASSEMBLY

Referring to the pictured quilt for rectangle size placement (or create your placement design), join the six assorted print 1½" x 2½" rectangles and the 12 assorted print 1" x 2½" rectangles to form a piano key unit. Press the seam allowances to one side, all in the same direction. The pieced Piano Key block should now measure 2½" x 12½", including the seam allowances.

PROJECT NOTES

This little sampler quilt combines several of Kim's favorite blocks and elements from collections 1 and 2 of her Simple Whatnots Club, and is filled with a variety of prints, colors, and fun-to-stitch techniques. For easy-to-follow instructions, the components that make up this quilt have been divided into a four-part series of handouts.

This project is designed to be scrap-friendly and incorporate a wide range of fabrics, so specific prints haven't been noted in the materials list. The pictured quilt uses a mix of fabrics from Kim's Vintage Farmhouse and Heritage Hollow collections, but any combination of prints can be used — let your stash be your guide!

The blocks and units that make up the quilt center are assembled in three horizontal rows before the patchwork border is pieced and added. For greater ease, cutting instructions are provided as each portion of the quilt top is stitched and assembled. The pictured quilt can be referred to as you cut your fabrics, or you can create your own mix of colors and placement of prints to personalize the look of your quilt. Please be sure to cut all pieces across the width of the fabric in the order given unless otherwise noted.

SUNDAY SUPPER BLOCK

FINISHED BLOCK SIZE:
4" x 4"



CUTTING

From assorted neutral prints, cut a combined total of:

12 squares, $1\frac{1}{8}$ " x $1\frac{1}{8}$ "; cut each square in half diagonally *once* to yield 2 triangles (combined total of 24)

12 squares, $1\frac{1}{2}$ " x $1\frac{1}{2}$ "

From each of three assorted prints, cut:

4 rectangles, $1\frac{1}{2}$ " x $2\frac{1}{2}$ " (combined total of 12)

From assorted prints, cut a combined total of:

3 squares, $2\frac{1}{2}$ " x $2\frac{1}{2}$ "

24 squares, $1\frac{1}{8}$ " x $1\frac{1}{8}$ "; cut each square in half diagonally *once* to yield a combined total of 48 triangles (Please note that you'll only use one triangle from each print. If you'd like to be more frugal in your cutting, simply use 12 squares, cutting each one in half to yield the 24 needed triangles. Each print will be used twice and with this approach, you'll have no waste. For the pictured project, Kim chose to randomly repeat some of the prints, and use other prints only once, adjusting the total number of triangles to be cut accordingly.)

BLOCK AND UNIT ASSEMBLY

- 1 Layer together a neutral print triangle and an assorted print triangle. Stitch the pair together along the long diagonal edges. Press the seam allowances toward the assorted print. Trim away the dog-ear points. Repeat for a total of 24 half-square-triangle units.

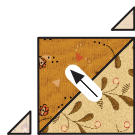

Make 24.

- 2 Use an acrylic ruler and a pencil to draw a diagonal sewing line on the wrong side of each half-square-triangle unit from step 1, drawing the lines so they cross over the seam.

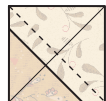

- 3 Select a $1\frac{1}{2}$ " x $2\frac{1}{2}$ " assorted print rectangle. Referring to the illustration, layer a prepared half-square-triangle unit onto one end of the rectangle. Stitch the pair together on the drawn line. Fold the resulting inner pieced triangle open, aligning the corner with the corner of the rectangle; press. Trim away the excess

layers beneath the top triangle, leaving a $\frac{1}{4}$ " seam allowance. In the same manner, layer, stitch, press, and trim a second prepared half-square-triangle onto the remaining end of the rectangle, positioning it in a mirror-image. Repeat with the remaining rectangles and half-square-triangle units, keeping the pieced rectangle point units organized by print in matching sets of four.

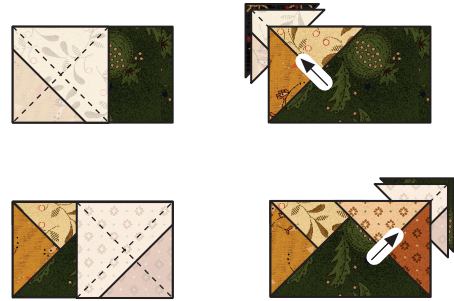

Make 12.

- 4 Select a set of four pieced point units from step 3. Referring to the illustration, join and press two point units to an assorted print $2\frac{1}{2}$ " square. Reserve the remaining two pieced point units.

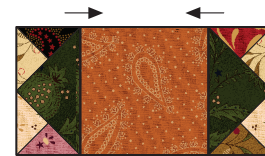

- 5 Join an assorted neutral print $1\frac{1}{2}$ " square to each end of the reserved pieced point units. Press the seam allowances toward the neutral squares.



Make 2.

- 6 Join a pieced unit from step 5 to each remaining side of the pieced step 4 unit, pressing the seams as shown.

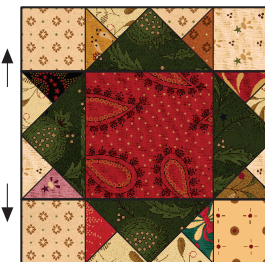

- 7 Repeat steps 4–6 for a total of three pieced Sunday Supper blocks measuring $4\frac{1}{2}$ " square, including the seam allowances.
- 8 Referring to the pictured quilt, join the three pieced blocks together end-to-end. Press the seam allowances open. The pieced Sunday Supper unit should now measure $4\frac{1}{2}$ " x $12\frac{1}{2}$ ", including the seam allowances.

MEANDERING BLOCK

FINISHED BLOCK SIZE:
6" x 6"



CUTTING

From each of two assorted neutral prints, cut:

1 square, 2 $\frac{7}{8}$ " x 2 $\frac{7}{8}$ "; cut each square in half diagonally *once* to yield 2 triangles (combined total of 4)

From one neutral print, cut:

8 squares, 1 $\frac{1}{2}$ " x 1 $\frac{1}{2}$ "

From assorted prints, cut a combined total of:

4 squares, 2 $\frac{7}{8}$ " x 2 $\frac{7}{8}$ "; cut each square in half diagonally *once* to yield a combined total of 8 triangles. (Please note that you'll only use one triangle from each print. If you'd like to be more frugal in your cutting, simply use 2 squares, cutting each one in half to yield the 4 needed triangles. Each print will be used twice and with this approach, you'll have no waste.)

8 squares, 1 $\frac{1}{2}$ " x 1 $\frac{1}{2}$ "

1 square, 2 $\frac{1}{2}$ " x 2 $\frac{1}{2}$ "

BLOCK ASSEMBLY

- 1 Select a neutral print and an assorted print 2 $\frac{7}{8}$ " triangle. Layer, stitch, press, and trim as instructed in step 1 of the Sunday Supper instructions, page 2. Repeat for a total of four half-square-triangles measuring 2 $\frac{1}{2}$ " square, including the seam allowances.

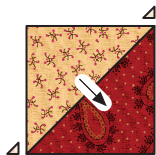

Make 4.

- 2 Join an assorted print 1 $\frac{1}{2}$ " square to a neutral print 1 $\frac{1}{2}$ " square. Press the seam allowances toward the assorted print. Repeat for a total of eight joined pairs.
- 3 Join and press two pairs from step 2 as shown to make a four-patch unit. Repeat for a total of four pieced four-patch units measuring 2 $\frac{1}{2}$ " square, including the seam allowances.



Make 4.

- 4 Referring to the illustration, lay out the four half-square-triangle units from step 1, the four pieced four-patch units from step 3, and the assorted print 2 $\frac{1}{2}$ " square to form a block. Join and press the pieces in each horizontal row as shown. Join and press the rows as shown. The pieced block should now measure 6 $\frac{1}{2}$ " square, including the seam allowances.

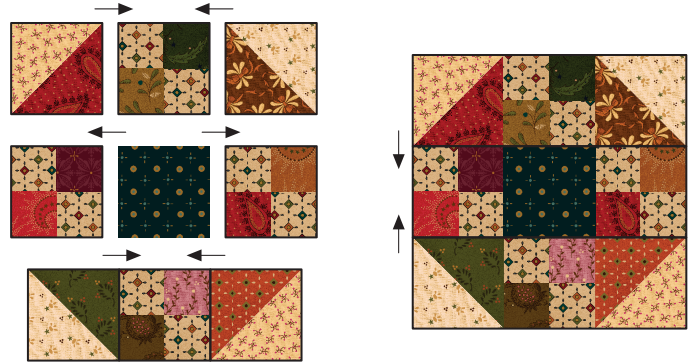

HOPSCOTCH FLYING GEESSE BLOCK

FINISHED BLOCK SIZE: 2" x 6"



CUTTING

From assorted neutral prints, cut a combined total of:

12 squares, 1 $\frac{1}{2}$ " x 1 $\frac{1}{2}$ "

From assorted prints, cut a combined total of:

6 rectangles, 1 $\frac{1}{2}$ " x 2 $\frac{1}{2}$ "

BLOCK ASSEMBLY

- 1 Using an acrylic ruler and a pencil, draw a diagonal sewing line on the wrong side of each assorted neutral print 1 $\frac{1}{2}$ " square.
- 2 Layer a prepared neutral print square onto one end of an assorted print 1 $\frac{1}{2}$ " x 2 $\frac{1}{2}$ " rectangle. Stitch the pair together on the drawn line. Fold the resulting inner triangle open, aligning the corner with the corner of the rectangle; press. Trim away the excess layers beneath the top triangle, leaving a $\frac{1}{4}$ " seam allowance. Repeat with a second prepared neutral square and the remaining end of the rectangle to form a mirror-image point. Repeat for a total of six flying geese units measuring 1 $\frac{1}{2}$ " x 2 $\frac{1}{2}$ ", including the seam allowances.



Make 6.

- 3 Referring to the pictured quilt, join the six flying geese units from step 2 to make a pieced Flying Geese block measuring $2\frac{1}{2}$ " x $6\frac{1}{2}$ ", including the seam allowances.

ASSEMBLING

ROW 3 OF THE QUILT CENTER

- 1 Using the pictured quilt as a guide, join the bottom edge of the Window Box Piano Key block to the top edge of the Sunday Supper unit. Press the seam allowances toward the Piano Key block.
- 2 Referring to the pictured quilt, join the right edge of the Meandering block to the left edge of the Hopscotch Flying Geese block. Press the seam allowance toward the Meandering block.
- 3 Using the pictured quilt as a guide, join the left edge of the pieced unit from step 2 to the right edge of the pieced unit from step 1. Press the seam allowances toward the Meandering block. The pieced Row 3 unit should now measure $6\frac{1}{2}$ " x $20\frac{1}{2}$ ", including the seam allowances.

SAMPLER QUILT

Part 4

Designed by Kim Diehl

Finished quilt size: 28½" x 28½"



provided as each portion of the quilt top is stitched and assembled. The pictured quilt can be referred to as you cut your fabrics, or you can create your own mix of colors and placement of prints to personalize the look of your quilt. Please be sure to cut all pieces across the width of the fabric in the order given unless otherwise noted.

Sew all pieces with right sides together and a ¼" seam allowance unless otherwise noted. For complete "How to Quilt" instructions, please visit shopmartingale.com/howtoquilt. Use your favorite technique for the appliqué portions of this sampler quilt, or refer to any of Kim's "Simple" series of books for her easy invisible machine-appliqué method.

MATERIALS

FOR ONE COMPLETE SAMPLER QUILT

- 2 fat quarters (18" x 22") of assorted neutral prints
- 5 fat eighths (9" x 22") of assorted neutral prints
- 20 chubby sixteenths (9" x 11") of assorted prints
- 20 charm squares (5" x 5") of assorted prints
- ½ yard of black print for sashing and binding
- 1 yard of fabric of your choice for backing
- 36" x 36" square of batting
- Bias bar to make ⅜"-wide stems
- Clover Quick Yo-Yo Maker, extra small
- Standard quilting supplies and supplies for your favorite appliqué method
- Liquid glue for fabric, water-soluble and acid-free (Quilter's Choice by Beacon Adhesives is Kim's favorite brand)

ASSEMBLING THE QUILT

QUILT CENTER

Referring to the pictured quilt, join the three previously pieced rows to form the quilt center. Press the seam allowances open. The pieced quilt center should now measure 20½" square, including the seam allowances.

PROJECT NOTES

This little sampler quilt combines several of Kim's favorite blocks and elements from collections 1 and 2 of her Simple Whatnots Club, and is filled with a variety of prints, colors, and fun-to-stitch techniques. For easy-to-follow instructions, the components that make up this quilt have been divided into a four-part series of handouts.

This project is designed to be scrap-friendly and incorporate a wide range of fabrics, so specific prints haven't been noted in the materials list. The pictured quilt uses a mix of fabrics from Kim's Vintage Farmhouse and Heritage Hollow collections, but any combination of prints can be used — let your stash be your guide!

The blocks and units that make up the quilt center are assembled in three horizontal rows before the patchwork border is pieced and added. For greater ease, cutting instructions are

INNER SASHING BORDER

CUTTING

From the black print, cut:

2 strips, $1\frac{1}{2}$ " x 42"; crosscut into 4 strips, $1\frac{1}{2}$ " x $20\frac{1}{2}$ "
Reserve the remaining black print for the outer border and binding.

From one neutral print, cut:

4 squares, $1\frac{1}{2}$ " x $1\frac{1}{2}$ "

BORDER ASSEMBLY

- 1 Join a black print $1\frac{1}{2}$ " x $20\frac{1}{2}$ " strip to the right and left sides of the quilt center. Press the seam allowances toward the black print.
- 2 Join a neutral print $1\frac{1}{2}$ " square to each end of the remaining black print $1\frac{1}{2}$ " x $20\frac{1}{2}$ " strips. Press the seam allowances toward the black print. Join these pieced strips to the remaining sides of the quilt center. Press the seam allowances toward the black print. The quilt top should now measure $22\frac{1}{2}$ " square, including the seam allowances.

QUILT CENTER APPLIQUÉ

Use your favorite method to appliqué the reserved Honeycomb hexies to the pieced background squares in row 1 of the quilt center.

OUTER BORDER

HOPSCOTCH FLYING GEESSE STRIP

FINISHED STRIP SIZE: 2" x 20"

CUTTING

From assorted neutral prints, cut a combined total of:

20 rectangles, $2\frac{1}{2}$ " x $4\frac{1}{2}$ "

From assorted prints, cut a combined total of:

40 squares, $2\frac{1}{2}$ " x $2\frac{1}{2}$ "

STRIP ASSEMBLY

- 1 Using an acrylic ruler and a pencil, draw a diagonal sewing line on the wrong side of each assorted print $2\frac{1}{2}$ " square.
- 2 Layer a prepared assorted print $2\frac{1}{2}$ " square onto one end of an assorted neutral print $2\frac{1}{2}$ " x $4\frac{1}{2}$ " rectangle. Stitch the pair together on the drawn line. Fold the resulting inner triangle open, aligning the corner with the corner of the rectangle; press. Trim away the excess layers beneath the top triangle, leaving a $\frac{1}{4}$ " seam allowance. Repeat with a second prepared assorted print square and the remaining end of the neutral rectangle

to form a mirror-image point. Repeat for a total of 20 flying geese units measuring $2\frac{1}{2}$ " x $4\frac{1}{2}$ ", including the seam allowances.

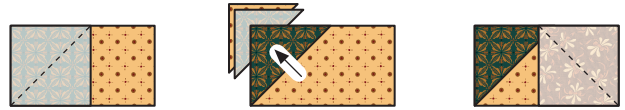

Make 20.

- 3 Referring to the pictured quilt, join five flying geese units together end to end. Press the seam allowances open. Repeat for a total of four pieced flying geese strips measuring $2\frac{1}{2}$ " x $20\frac{1}{2}$ ", including the seam allowances.

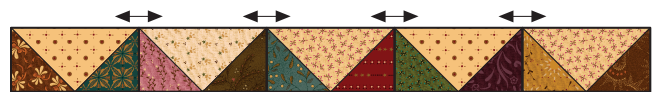

Make 4.

LAUNDRY DAY CHECKERBOARD STRIP

FINISHED STRIP SIZE: 1" x 20"

CUTTING

From assorted prints, cut a combined total of:

80 squares, $1\frac{1}{2}$ " x $1\frac{1}{2}$ "

STRIP ASSEMBLY

Using the pictured quilt as a guide, join 20 assorted print $1\frac{1}{2}$ " squares together end to end to make a checkerboard strip. Press the seam allowances open. Repeat for a total of four pieced checkerboard strips measuring $1\frac{1}{2}$ " x $20\frac{1}{2}$ ", including the seam allowances.

ADDING THE OUTER BORDER

CUTTING

From assorted prints, cut a combined total of:

4 squares, $3\frac{1}{2}$ " x $3\frac{1}{2}$ "

From the reserved black print, cut:

1 strip, $1\frac{1}{2}$ " x 42"; crosscut into 8 rectangles, $1\frac{1}{2}$ " x $3\frac{1}{2}$ "

Reserve the remaining black print for the binding.

BORDER ASSEMBLY

- 1 Referring to the pictured quilt, join a pieced checkerboard strip to the long neutral edge of a pieced flying geese strip. Press the seam allowances toward the checkerboard. Repeat for a total of four pieced border units measuring $3\frac{1}{2}$ " x $20\frac{1}{2}$ ", including the seam allowances.

- 2 Using the pictured quilt as a guide, join a black print $1\frac{1}{2}$ " x $3\frac{1}{2}$ " rectangle to the short ends of each pieced border unit. Press the seam allowances toward the black print. Join two of these pieced units to the right and left sides of the quilt top. Press the seam allowances toward the black sashing strips. Reserve the remaining pieced units for use in step 3.
- 3 Join an assorted print $3\frac{1}{2}$ " square to each end of the reserved pieced units from step 2. Press the seam allowances toward the assorted print squares. Referring to the pictured quilt, join these units to the remaining sides of the quilt center. Press the seam allowances toward the black sashing strips. The pieced quilt top should now measure $28\frac{1}{2}$ " square, including the seam allowances.

COMPLETING THE QUILT

CUTTING

From the remainder of the reserved black print, cut:
4 binding strips, $2\frac{1}{2}$ " x 42"

ASSEMBLY

Layer the quilt top, batting, and backing. Quilt the layers. Join the strips of black print into one length and use it to bind the quilt.